



East Lothian Council
Licensing
- 6 DEC 2024
Received

APPLICATION FOR VARIATION OTHER THAN MINOR VARIATION

3

LICENSING (SCOTLAND) ACT 2005, SECTION 29

**This application should only be completed by the Licence Holder
of the appropriate Premises Licence or their Agent.**

1. TYPE OF VARIATION

This application for Variation other than a Minor Variation of Premises Licence is made under Section 29(5) of the Licensing (Scotland) Act 2005 in order to vary - (Tick all relevant boxes)

- Any of the Conditions to which the Premises Licence is subject
- Any of the information contained within the Operating Plan
- The Layout Plan
- Any other information contained or referred to in the licence (including any addition, deletion or other modification).

(Provide Details)

Amendments to store layout, including increase in permanent off-sales display capacity

2. PREMISES LICENCE DETAILS

2(a) Licence Number of Premises EL0153

2(b) Name and Address of Premises _____

ALDI, 48-52 DUNBAR ROAD, NORTH BERWICK

Post Code EH39 5AB Tel. No. _____

Email _____

2(c) Full Name and Address of Current Licence Holder

ALDI STORES LIMITED

Holly Lane, Atherstone, Warwickshire

_____ Post Code CV9 2SQ

Tel. No. Agent - [REDACTED] Email address Agent - Lynn.Simpson@TLT.com

3. NATURE OF VARIATION

Complete the relevant section(s) regarding the variations sought -

3(a) Variation to the Conditions to which the Premises Licence is subject

Provide details of the Condition(s) to be varied and the variation being sought

n/a

3(b) Variation to the information contained within the Operating Plan of the Premises Licence

Provide a copy of the proposed operating plan and detail below the proposed changes. (See Note 1)

INCREASE PERMANENT OFF-SALES CAPACITY FROM 32.76801sqm TO 37.78301sqm

3(c) Variation to the Layout Plan of the Premises Licence

A copy of the proposed Layout Plan must accompany this application. (See Note 2)
In addition please provide details below of the proposed change to the layout of the Premises.

MINOR RECONFIGURATION OF STORE LAYOUT, RESULTING IN INCREASE OF PERMANENT OFF-SALES CAPACITY FROM 32.76801sqm TO 37.78301sqm

3(d) Variation to any other information contained or referred to in the licence

Provide details below of any other variation sought to the Premises Licence (e.g. Alteration to the description of the premises contained within the Premises Licence)

n/a

4. LICENCE TO BE AMENDED (See note 3 below)

Does the appropriate Premises Licence accompany this application?

YES NO

If the answer is NO, please provide an explanation.

I am unable to produce the Premises Licence because –

- The licence has not yet been issued by the Board
- The licence has already been returned to the Board in respect of an earlier application for variation or transfer
- Other (provide details)

TO FOLLOW - IF REQUIRED

5. FEE PAYABLE

Information on fees can be found at

https://www.eastlothian.gov.uk/info/210571/licensing/12259/alcohol_licences/2

If submitted with an application for transfer, please specify the order in which the applications are to be considered–

- Application for Transfer of Premises Licence followed by Application for Variation
- Application for Variation followed by Application for Transfer of Premises Licence

DECLARATION BY APPLICANT OR AGENT ON BEHALF OF APPLICANT

If signing on behalf of the applicant please state in what capacity.

I confirm that

(a) the contents of this Application are true to the best of my knowledge and belief; and

(b) (i) the appropriate fee of £ 200 is enclosed

(ii) the proposed Operating Plan is enclosed

(iii) the proposed Layout Plan is enclosed

(iv) the Premises Licence is enclosed TO FOLLOW - IF REQUIRED

Signature [Redacted] (See note 5 overleaf)
LYNN SIMPSON (TLT LLP) as Agent

Date 5 December 2024

Capacity APPLICANT / AGENT (delete as appropriate)

If agent, please provide details

Full name LYNN SIMPSON (TLT LLP) as Agent

Address TLT Solicitors, Cadworks, Floor 9, 41 West Campbell Street, Glasgow

Post Code G2 6SE

Tel. No. [Redacted] Email address Lynn.Simpson@TLT.com

Note 1

Please note that the proposed Operating Plan must contain any aspects of the current Operating Plan that are to be preserved should the variation be granted. (e.g. If the current Operating Plan allows a premises to have 'live performances' but this is not requested on the proposed Operating Plan then the Licensing Board would view such an omission as a request to have 'live performances' deleted from the Operating Plan of the Premises.)

OPERATING PLAN

Licensing (Scotland) Act 2005, section 20(2)(b)(i)

Question 1

STATEMENT REGARDING ALCOHOL BEING SOLD ON PREMISES/OFF PREMISES OR BOTH

<i>1(a) Will alcohol be sold for consumption solely ON the premises?</i>	NO
<i>1(b) Will alcohol be sold for consumption solely OFF the premises?</i>	YES
<i>1(c) Will alcohol be sold for consumption both ON and OFF the premises?</i>	NO
<i>*Delete as appropriate</i>	

Question 2

STATEMENT OF CORE TIMES WHEN ALCOHOL WILL BE SOLD FOR CONSUMPTION ON PREMISES

<i>Day</i>	<i>ON Consumption</i>	
	<i>Opening time</i>	<i>Terminal hour</i>
<i>Monday</i>	N/A	N/A
<i>Tuesday</i>	N/A	N/A
<i>Wednesday</i>	N/A	N/A
<i>Thursday</i>	N/A	N/A
<i>Friday</i>	N/A	N/A
<i>Saturday</i>	N/A	N/A
<i>Sunday</i>	N/A	N/A

Question 3

STATEMENT OF **CORE** TIMES WHEN ALCOHOL WILL BE SOLD FOR CONSUMPTION **OFF** PREMISES

<i>Day</i>	<i>OFF Consumption</i>	
	<i>Opening time</i>	<i>Terminal hour</i>
<i>Monday</i>	10.00AM	10.00PM
<i>Tuesday</i>	10.00AM	10.00PM
<i>Wednesday</i>	10.00AM	10.00PM
<i>Thursday</i>	10.00AM	10.00PM
<i>Friday</i>	10.00AM	10.00PM
<i>Saturday</i>	10.00AM	10.00PM
<i>Sunday</i>	10.00AM	10.00PM

Question 4

SEASONAL VARIATIONS

<i>Does the applicant intend to operate according to seasonal demand</i>	NO
--	----

**If YES – provide details*

N/A

Question 5

PLEASE INDICATE THE OTHER ACTIVITIES OR SERVICES THAT WILL BE PROVIDED ON THE PREMISES IN ADDITION TO SUPPLY OF ALCOHOL

COL. 1 5(a) Activity	COL. 2 Please confirm YES/NO	COL. 3 To be provided during core licensed hours – please confirm YES/NO	COL. 4 Where activities are also to be provided outwith core licensed hours please confirm YES/NO
Accommodation	NO	NO	NO
Conference facilities	NO	NO	NO
Restaurant facilities	NO	NO	NO
Bar meals	NO	NO	NO
5(b) Activity Social functions including:	Please confirm YES/NO	To be provided during core licensed hours – please confirm YES/NO	Where activities are also to be provided outwith core licensed hours please confirm YES/NO
Receptions including Weddings, funerals, birthdays, retirements etc.	NO	NO	NO
Club or other group meetings etc.	NO	NO	NO
5(c) Activity Entertainment including:	Please confirm YES/NO	To be provided during core licensed hours – please confirm YES/NO	Where activities are also to be provided outwith core licensed hours please confirm YES/NO
Recorded music – see 5(g)	YES	YES	YES
Live performances – see 5(g)	NO	NO	NO
Dance facilities	NO	NO	NO
Theatre	NO	NO	NO

<i>Films</i>	NO	NO	NO
<i>Gaming</i>	NO	NO	NO
<i>Indoor/outdoor sports</i>	NO	NO	NO
<i>Televised sport</i>	NO	NO	NO
5(d) <i>Activity</i>	Please confirm YES/NO	To be provided during core licensed hours – please confirm YES/NO	Where activities are also to be provided outwith core licensed hours please confirm YES/NO
<i>Outdoor drinking facilities</i>	NO	NO	NO
5(e) <i>Activity</i>	Please confirm YES/NO	To be provided during core licensed hours – please confirm YES/NO	Where activities are also to be provided outwith core licensed hours please confirm YES/NO
<i>Adult entertainment</i>	NO	NO	NO

Where you have answered YES in respect of any entry in column 4 above, please provide further details below.

Recorded background music may be played within and outwith core hours.

5(f) any other activities

If you propose to provide any activities other than those listed in 5(a) – (e) please provide details or further information in the box below.

Sale of goods consistent with the business of a supermarket both within and outwith core hours, at all times 24/7, provided the requisite permissions are in place.

Click and collect service and on line sales/deliveries may also take place during and outwith core hours.

5(g) Late night premises opening after 1.00am

Where you have confirmed that you are providing live or recorded music, will the decibel level exceed 85dB?	N/A
When fully occupied, are there likely to be more customers standing than seated?	N/A
*Delete as appropriate	

Question 6 (On-sales only)

CHILDREN AND YOUNG PERSONS

6(a)	When alcohol is being sold for consumption on the premises will children or young persons be allowed entry	NO
*Delete as appropriate		

6(b) Where the answer to 6(a) is YES provide statement of the **TERMS** under which they will be allowed entry

N/A

6(c) Provide statement regarding the **AGES** of children or young persons to be allowed entry

N/A

6(d) Provide statement regarding the **TIMES** during which children and young persons will be allowed entry

N/A

6(e) Provide statement regarding the **PARTS** of the premises to which children and young persons will be allowed entry

N/A

Question 7

CAPACITY OF PREMISES

What is the proposed capacity of the premises to which this application relates?

Off sales – 44.98301m²

Permanent - 37.78301m²

Seasonal – 7.2m²

Question 8

REMISES MANAGER (NOTE: not required where application is for grant of provisional premises licence)

Personal details

8(a) *Name*

PETER ROBERT GREASLEY

8(b) *Date of birth*

[REDACTED]

8(c) *Contact address*

[REDACTED]

8(d) *Email address*

[REDACTED]

8(e) Personal licence

<i>Date of issue</i>	<i>Name of Licensing Board issuing</i>	<i>Reference no. of personal licence</i>
26 JAN 2017	EAST LoTHIAN	EL1360

DECLARATION BY APPLICANT OR AGENT ON BEHALF OF APPLICANT

If signing on behalf of the applicant please state in what capacity.

The contents of this operating plan are true to the best of my knowledge and belief.

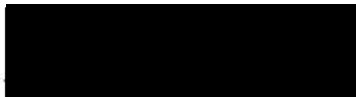
Signature  * (see note below)

Date 5 DECEMBER 2024

Capacity ... LYNN SIMPSON (TLT LLP) as Agent ... AGENT (delete as appropriate).

Telephone number and email address of signatory 0333 006 0923 / 
Lynn.Simpson@TLT.com

*** Data Protection Act 1998**

The information on this form may be held on an electronic public register which may be available to members of the public on request.

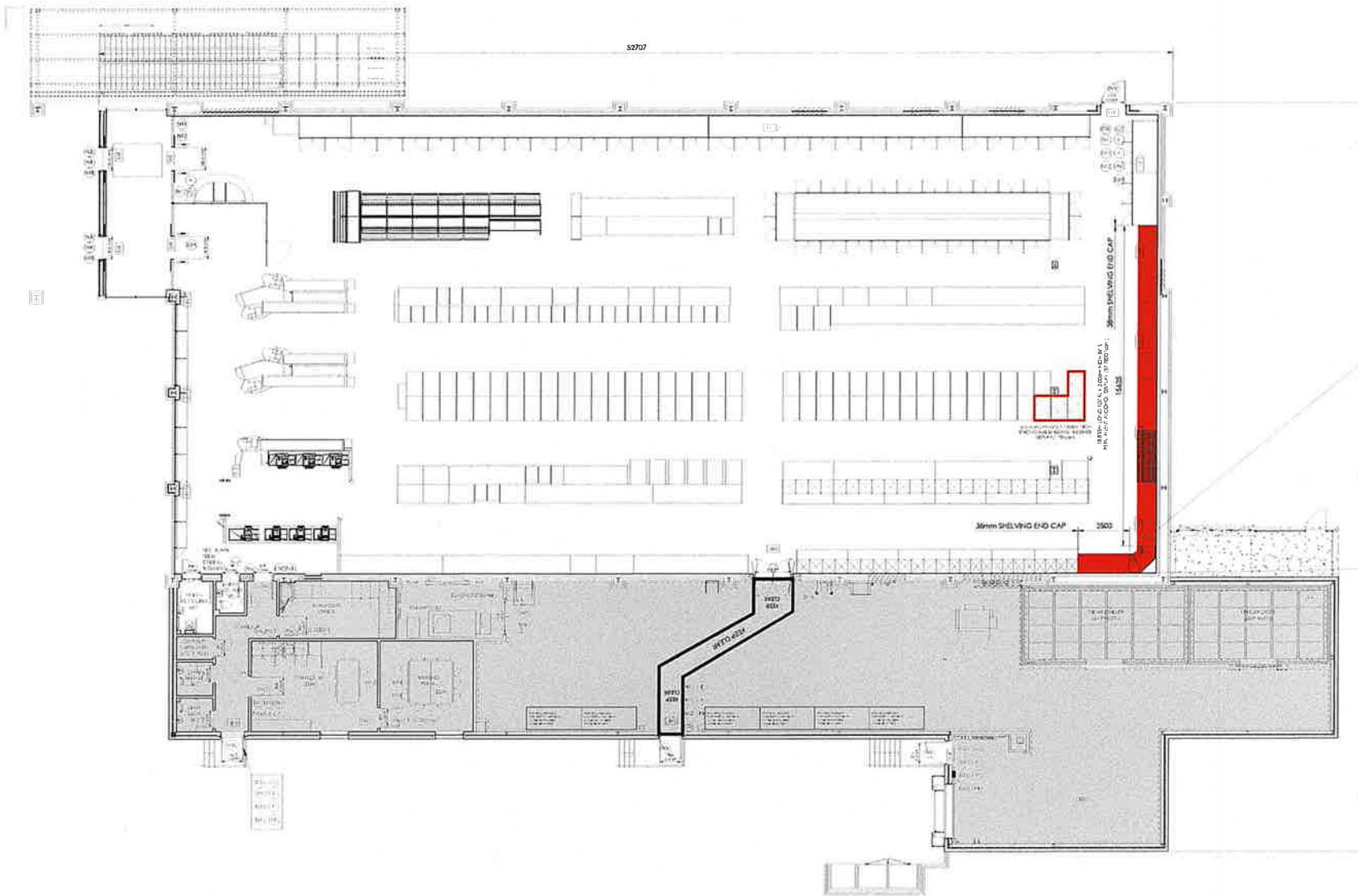

BWS CORNER DETAIL
SCALE 1:20

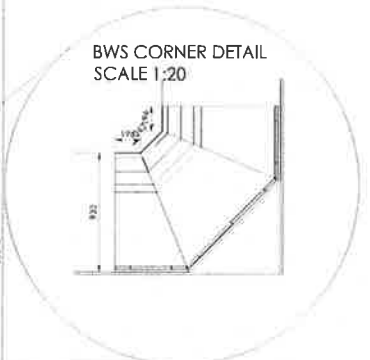

ALCOHOL MERCHANDISE LEGEND

█ PERMANENT ALCOHOL DISPLAY

█ SEASONAL ALCOHOL DISPLAY
CHRISTMAS: 1ST DECEMBER TO 31ST DECEMBER ANNUALLY.
EASTER SEASONAL LICENCE TO COMMENCE A WEEK PRIOR TO EASTER SUNDAY. (AS IT FALLS FOR A DURATION OF 21 DAYS)

█ NON-PUBLIC AREA

NOTE:
NO SPECIFIC AREA FOR USE OF CHILDREN ONLY. CHILDREN AND YOUNG PERSONS ARE PERMITTED BY ALL PUBLIC AREAS OF THE PREMISES.

- | | |
|---|--|
| <ul style="list-style-type: none"> (11) GENERAL FIRE NOTICE Ref 1/1033/K (12) EMERGENCY EXIT ONLY SIGN 450 x 100mm SELF ADHESIVE VINYL (13) "KEEP CLEAR" SIGN 200 x 200mm SELF ADHESIVE VINYL (14) DIRECTION ARROW SIGN WHITE ARROW ON BLUE CIRCLE ON WHITE SQUARE 200 x 200mm (15) "FIRE EXIT KEEP CLEAR" SIGN 200 x 200mm MOUNTED EXTERNALLY (16) "FIRE DOOR KEEP CLOSED" SIGN 80 x 80mm SELF ADHESIVE (17) "FIRE DOOR KEEP CLOSED" SIGN 80 x 80mm (18) "FIRE DOOR KEEP LOCKED" SIGN 200 x 80mm (19) "AUTOMATIC DOORS" SIGN BLACK LETTERS ON WHITE 200 x 200 SELF ADHESIVE (20) FIRE ALARM CALL POINT SIGN 80 x 80mm SELF ADHESIVE (21) FIRE ALARM CALL POINT SIGN 150 x 200mm (22) "FIRE EXTINGUISHER" SIGN 150 x 200mm (23) "FIRE EXTINGUISHER" SIGN 150 x 200mm (24) "FIRE EXTINGUISHER" SIGN 150 x 200mm (25) "FIRE EXTINGUISHER" SIGN 150 x 200mm (26) "FIRE EXTINGUISHER" SIGN 150 x 200mm (27) "FIRE EXTINGUISHER" SIGN 150 x 200mm (28) "FIRE EXTINGUISHER" SIGN 150 x 200mm (29) "FIRE EXTINGUISHER" SIGN 150 x 200mm (30) "FIRE EXTINGUISHER" SIGN 150 x 200mm (31) "FIRE EXTINGUISHER" SIGN 150 x 200mm (32) "FIRE EXTINGUISHER" SIGN 150 x 200mm (33) "FIRE EXTINGUISHER" SIGN 150 x 200mm (34) "FIRE EXTINGUISHER" SIGN 150 x 200mm (35) "FIRE EXTINGUISHER" SIGN 150 x 200mm (36) "FIRE EXTINGUISHER" SIGN 150 x 200mm (37) "FIRE EXTINGUISHER" SIGN 150 x 200mm (38) "FIRE EXTINGUISHER" SIGN 150 x 200mm (39) "FIRE EXTINGUISHER" SIGN 150 x 200mm (40) "FIRE EXTINGUISHER" SIGN 150 x 200mm (41) "FIRE EXTINGUISHER" SIGN 150 x 200mm (42) "FIRE EXTINGUISHER" SIGN 150 x 200mm (43) "FIRE EXTINGUISHER" SIGN 150 x 200mm (44) "FIRE EXTINGUISHER" SIGN 150 x 200mm (45) "FIRE EXTINGUISHER" SIGN 150 x 200mm (46) "FIRE EXTINGUISHER" SIGN 150 x 200mm (47) "FIRE EXTINGUISHER" SIGN 150 x 200mm (48) "FIRE EXTINGUISHER" SIGN 150 x 200mm (49) "FIRE EXTINGUISHER" SIGN 150 x 200mm (50) "FIRE EXTINGUISHER" SIGN 150 x 200mm (51) "FIRE EXTINGUISHER" SIGN 150 x 200mm (52) "FIRE EXTINGUISHER" SIGN 150 x 200mm (53) "FIRE EXTINGUISHER" SIGN 150 x 200mm (54) "FIRE EXTINGUISHER" SIGN 150 x 200mm (55) "FIRE EXTINGUISHER" SIGN 150 x 200mm (56) "FIRE EXTINGUISHER" SIGN 150 x 200mm (57) "FIRE EXTINGUISHER" SIGN 150 x 200mm (58) "FIRE EXTINGUISHER" SIGN 150 x 200mm (59) "FIRE EXTINGUISHER" SIGN 150 x 200mm (60) "FIRE EXTINGUISHER" SIGN 150 x 200mm (61) "FIRE EXTINGUISHER" SIGN 150 x 200mm (62) "FIRE EXTINGUISHER" SIGN 150 x 200mm (63) "FIRE EXTINGUISHER" SIGN 150 x 200mm (64) "FIRE EXTINGUISHER" SIGN 150 x 200mm (65) "FIRE EXTINGUISHER" SIGN 150 x 200mm (66) "FIRE EXTINGUISHER" SIGN 150 x 200mm (67) "FIRE EXTINGUISHER" SIGN 150 x 200mm (68) "FIRE EXTINGUISHER" SIGN 150 x 200mm (69) "FIRE EXTINGUISHER" SIGN 150 x 200mm (70) "FIRE EXTINGUISHER" SIGN 150 x 200mm (71) "FIRE EXTINGUISHER" SIGN 150 x 200mm (72) "FIRE EXTINGUISHER" SIGN 150 x 200mm (73) "FIRE EXTINGUISHER" SIGN 150 x 200mm (74) "FIRE EXTINGUISHER" SIGN 150 x 200mm (75) "FIRE EXTINGUISHER" SIGN 150 x 200mm (76) "FIRE EXTINGUISHER" SIGN 150 x 200mm (77) "FIRE EXTINGUISHER" SIGN 150 x 200mm (78) "FIRE EXTINGUISHER" SIGN 150 x 200mm (79) "FIRE EXTINGUISHER" SIGN 150 x 200mm (80) "FIRE EXTINGUISHER" SIGN 150 x 200mm (81) "FIRE EXTINGUISHER" SIGN 150 x 200mm (82) "FIRE EXTINGUISHER" SIGN 150 x 200mm (83) "FIRE EXTINGUISHER" SIGN 150 x 200mm (84) "FIRE EXTINGUISHER" SIGN 150 x 200mm (85) "FIRE EXTINGUISHER" SIGN 150 x 200mm (86) "FIRE EXTINGUISHER" SIGN 150 x 200mm (87) "FIRE EXTINGUISHER" SIGN 150 x 200mm (88) "FIRE EXTINGUISHER" SIGN 150 x 200mm (89) "FIRE EXTINGUISHER" SIGN 150 x 200mm (90) "FIRE EXTINGUISHER" SIGN 150 x 200mm (91) "FIRE EXTINGUISHER" SIGN 150 x 200mm (92) "FIRE EXTINGUISHER" SIGN 150 x 200mm (93) "FIRE EXTINGUISHER" SIGN 150 x 200mm (94) "FIRE EXTINGUISHER" SIGN 150 x 200mm (95) "FIRE EXTINGUISHER" SIGN 150 x 200mm (96) "FIRE EXTINGUISHER" SIGN 150 x 200mm (97) "FIRE EXTINGUISHER" SIGN 150 x 200mm (98) "FIRE EXTINGUISHER" SIGN 150 x 200mm (99) "FIRE EXTINGUISHER" SIGN 150 x 200mm (100) "FIRE EXTINGUISHER" SIGN 150 x 200mm | <ul style="list-style-type: none"> (11) "FIRE EXTINGUISHER" SIGN 150 x 200mm SELF ADHESIVE (12) "NO SMOKING" SIGN 200 x 200mm (13) "FIRE BLANKET" SIGN 75 x 210mm (14) "MIND YOUR HEAD" SIGN 400 x 100mm (15) "MIND THE STEP" SIGN 400 x 100mm (16) "WAY IN / NO EXIT" SELF ADHESIVE VINYL SIGN (17) "WAY OUT / NO ENTRY" SELF ADHESIVE VINYL SIGN (18) "FIRE ALARM CONTROL PANEL" SIGN 200 x 150mm (19) DIRECTIONAL FIRE EXIT SIGN 600 x 200mm LEFT HAND (20) DIRECTIONAL FIRE EXIT SIGN 600 x 200mm RIGHT HAND (21) DIRECTIONAL FIRE EXIT SIGN 300 x 100mm LEFT HAND (22) ILLUMINATED FIRE EXIT SIGN (23) PUSH BAR MECHANISM AND "PUSH BAR TO OPEN" SIGN 600 x 100mm (ON DOOR) (24) FIRE EXIT SIGN 705 x 150mm (ON DOOR) (25) FIRE ALARM CALL POINT (BREAK GLASS UNIT) (26) FOAM SPRAY AFF FIRE EXTINGUISHER (27) CARBON DIOXIDE FIRE EXTINGUISHER (28) FIRE BLANKET (29) SMOKE DETECTOR (30) VOID MOUNTED SMOKE DETECTOR WITH CEILING MOUNTED INDICATOR (31) FIRE ALARM SMOKE DETECTOR & SOUNDER (32) FIRE ALARM HEAT DETECTOR & SOUNDER (33) FIRE ALARM CONTROL PANEL (34) FIRE ALARM BELL |
|---|--|

0 1000 2000 3000 4000 5000mm
SCALE 1:100

KEY PLAN - 1:1250

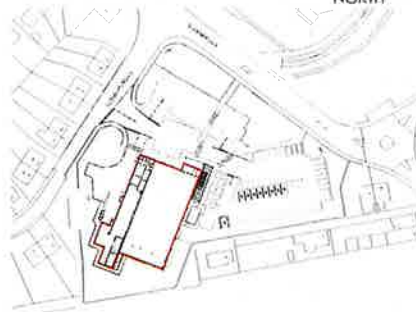

Architecture
Masterplanning
Interior Design

THE HARRIS PARTNERSHIP

ALDI STORES LTD.

ALCOHOL LICENCE PLAN

DUNBAR ROAD, NORTH BERRICK, EH39 4DD

77-E1030 THP XX 00 DR A 0307

EAST LoTHIAN COUNCIL

Licensing Standards

From: Licensing Standards Officer

To: C. Grilli

Clerk to the Licensing Board

Date: 20th December 2024

Subject: LICENSING (SCOTLAND) ACT 2005

PREMISES LICENCE MAJOR VARIATION

EL053, ALDI, 48-52 DUNBAR ROAD, NORTH BERWICK, EAST LoTHIAN EH39 5AB

I can confirm that the premises have been visited in relation to this variation application. The site notice was correctly displayed.

The changes applied for are:

- To increase the off sales capacity on the operating plan
- To amend the layout plan for the increased capacity

I have received no complaints about the premises and have no adverse comment in relation to the changes.

Licensing Standards Officer

Licensing

From: Iain Anderson <Iain.Anderson3@scotland.police.uk>
Sent: 11 December 2024 09:48
To: Licensing
Subject: MAJOR VARIATION - ALDI, NORTH BERWICK - LAYOUT CHANGE & INCREASE IN ALCOHOL CAPACITY
Attachments: LIC38 PREMISES VARIATION - NO ADVERSE COMMENT ALDI, NORTH BERWICK.RTF

CAUTION: This email originated from outside of the organisation. Do not click links or open attachments unless you recognise the sender and know the content is safe.

Hi all,
No Police objection
Our ref - 883949

Regards
Iain

Herkes, Gillian

From: Muir, Marion
Sent: 10 December 2024 17:06
To: Licensing
Cc: Herkes, Gillian; Trading Standards
Subject: FW: Application for major variation - Aldi Stores Limited -#58 Aldi, 48-52 Dunbar Road, North Berwick, EH39 5AB (EL0153)
Attachments: Signed Major_Variation_application - #58 Aldi, North Berwick - PFE2025.pdf; Proposed Operating Plan - Aldi #58 North Berwick (PFE2025).pdf; 79-E1030-THP-XX-00-DR-A-0307-P01-ALCOHOLLICENCEPLAN.pdf

Dear Licensing

Hope you are all well.

In relation to the attached application (which relates to an increase of permanent off-sales capacity), I would advise that Business Regulation- Environmental Health (Food and Safety) have no objections to this application. I have copied this email to colleagues in Trading Standards for their information.

Best regards

Marion

Marion Muir, Business Compliance- Environmental Health, East Lothian Council
01620 827234/07990 540729

From: Environmental Health/Trading Standards <ehts@eastlothian.gov.uk>
Sent: Tuesday, December 10, 2024 3:54 PM
To: Muir, Marion <mmuir@eastlothian.gov.uk>
Subject: FW: Application for major variation - Aldi Stores Limited -#58 Aldi, 48-52 Dunbar Road, North Berwick, EH39 5AB (EL0153)

From: Licensing <licensing@eastlothian.gov.uk>
Sent: Tuesday, December 10, 2024 1:36 PM
To: Lothian & borders Police (lothianscotborderslicensingeastmid@scotland.pnn.police.uk) <lothianscotborderslicensingeastmid@scotland.pnn.police.uk>; Licensing Standards Officer <lso@eastlothian.gov.uk>; Environmental Health/Trading Standards <ehts@eastlothian.gov.uk>; Environment Reception <environment@eastlothian.gov.uk>; Torquil Cramer (torquil.cramer@firescotland.gov.uk) <torquil.cramer@firescotland.gov.uk>; 'kat.burke@nhs.scot' <kat.burke@nhs.scot>; secretary@northberwickcommunitycouncil.org.uk
Subject: FW: Application for major variation - Aldi Stores Limited -#58 Aldi, 48-52 Dunbar Road, North Berwick, EH39 5AB (EL0153)

Hi

Licensing

From: Robertson, Scott
Sent: 11 December 2024 10:17
To: Licensing
Subject: RE: Application for major variation - Aldi Stores Limited -#58 Aldi, 48-52 Dunbar Road, North Berwick, EH39 5AB (EL0153)

Hello,

I have no comments or objections to this variation application.

Regards
Scott

Scott Robertson | Assistant Planner – Planning Delivery | East Lothian Council | John Muir House | Haddington EH41 3HA
T. 01620 827585 | E.srobertson2@eastlothian.gov.uk Visit our website at www.eastlothian.gov.uk

From: Licensing <licensing@eastlothian.gov.uk>
Sent: Tuesday, December 10, 2024 1:36 PM
To: Lothian & borders Police (lothianscotborderslicensingeastmid@scotland.pnn.police.uk) <lothianscotborderslicensingeastmid@scotland.pnn.police.uk>; Licensing Standards Officer <iso@eastlothian.gov.uk>; Environmental Health/Trading Standards <ehts@eastlothian.gov.uk>; Environment Reception <environment@eastlothian.gov.uk>; Torquil Cramer (torquil.cramer@firescotland.gov.uk) <torquil.cramer@firescotland.gov.uk>; 'kat.burke@nhs.scot' <kat.burke@nhs.scot>; secretary@northberwickcommunitycouncil.org.uk
Subject: FW: Application for major variation - Aldi Stores Limited -#58 Aldi, 48-52 Dunbar Road, North Berwick, EH39 5AB (EL0153)

Hi

Please find attached Major Variation for Aldi Stores, 48-52 Dunbar Road, North Berwick for report/representation by 2nd January 2025.

Kind regards

Gillian

Gillian Herkes
Licensing Officer
Democratic & Licensing Services
John Muir House
Haddington
East Lothian Council
01620 820114
gherkes@eastlothian.gov.uk

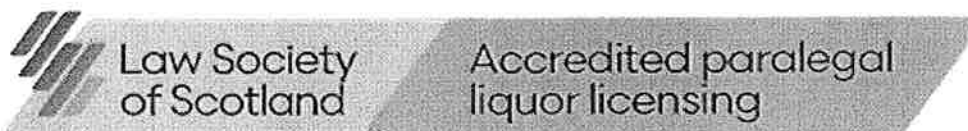

Herkes, Gillian

From: Trading Standards
Sent: 11 December 2024 13:09
To: Licensing
Cc: Herkes, Gillian
Subject: RE: Application for major variation - Aldi Stores Limited -#58 Aldi, 48-52 Dunbar Road, North Berwick, EH39 5AB (EL0153)

Good afternoon, TS have no issue with the above.

Kind regards

Gillian

From: Muir, Marion <mmuir@eastlothian.gov.uk>
Sent: Tuesday, December 10, 2024 5:06 PM
To: Licensing <licensing@eastlothian.gov.uk>
Cc: Herkes, Gillian <gherkes@eastlothian.gov.uk>; Trading Standards <tradingstandards@eastlothian.gov.uk>
Subject: FW: Application for major variation - Aldi Stores Limited -#58 Aldi, 48-52 Dunbar Road, North Berwick, EH39 5AB (EL0153)

Dear Licensing

Hope you are all well.

In relation to the attached application (which relates to an increase of permanent off-sales capacity), I would advise that Business Regulation- Environmental Health (Food and Safety) have no objections to this application. I have copied this email to colleagues in Trading Standards for their information.

Best regards

Marion

Marion Muir, Business Compliance- Environmental Health, East Lothian Council
01620 827234/07990 540729

From: Environmental Health/Trading Standards <ehts@eastlothian.gov.uk>
Sent: Tuesday, December 10, 2024 3:54 PM
To: Muir, Marion <mmuir@eastlothian.gov.uk>
Subject: FW: Application for major variation - Aldi Stores Limited -#58 Aldi, 48-52 Dunbar Road, North Berwick, EH39 5AB (EL0153)

From: Licensing <licensing@eastlothian.gov.uk>
Sent: Tuesday, December 10, 2024 1:36 PM
To: Lothian & borders Police (lothianscotborderslicensingeastmid@scotland.pnn.police.uk)
<lothianscotborderslicensingeastmid@scotland.pnn.police.uk>; Licensing Standards Officer