

EL403



# APPLICATION FOR PREMISES LICENCE / PROVISIONAL PREMISES LICENCE\*

LICENSING (SCOTLAND) ACT 2005, SECTION 20

\*Delete as appropriate

# 2a

**Question 1** – Name, address and postcode of premises to be licensed

Tesco Express

---

Unit 1, Futures Way, Wallyford

---

EH21 8FF

---

**Question 2** – Particulars of applicant

**2(a)** Where applicant is an individual, provide full name, date & place of birth, home address including postcode, telephone number & email address.

---

---

---

---

**2(b)** Where applicant is a partnership, please provide full name, and postal address of partnership.

---

---

---

**2(c)** Where applicant is a company, please provide name, registered office and company registration number.

PTLL Limited

---

Tesco House, Shire Park, Kestrel Way, Welwyn Garden City

---

AL7 1GA

---

Company Reg. No. 08926930

---

**2(d)** Where the applicant is a club or other body, please provide full name, and postal address of club or other body.

---

---

---

---

**2(e)** Where applicant is a partnership, company, club or other body, please provide the names, dates and places of birth, and home addresses of connected persons.\*

See attached list

---

---

---

---

\* Connected person is defined in section 147(3) of the Licensing (Scotland) Act 2005.

**Question 3** – Previous applications

Has the applicant been refused a premises licence under section 23 of the Licensing (Scotland) Act 2005 in respect of the same premises?

YES  NO

If YES – provide full details \_\_\_\_\_  
\_\_\_\_\_  
\_\_\_\_\_

**Question 4** – Previous convictions

Has the applicant or any connected person ever been convicted of a relevant or foreign offence (1)

YES  NO

If YES – provide full details. For the purpose of this Act, a conviction for a relevant offence or foreign offence is to be disregarded if it is spent for the purpose of the Rehabilitation of Offenders Act 1974.

NAME	DATE	COURT	OFFENCE	SENTENCE

(1) In addition to any convictions held by the applicant at the time of application, applicants should also familiarise themselves with the contents of section 24(1) of the Licensing (Scotland) Act 2005 in respect of any convictions for relevant or foreign offences which they may receive during the period beginning with the making of the premises licence application and ending with determination of the application.

**DESCRIPTION OF PREMISES**  
**Licensing (Scotland) Act 2005, section 20(2)(a)**

**Question 5** Description of premises

(where application is submitted by a members' club, please also complete question 6)

Convenience store located within new retail development in Wallyford.

---

---

---

**Question 6** – To be completed by members' clubs only

Do the club's constitution and rules conform to the requirements of regulation 2 of the Licensing (Clubs) (Scotland) Regulations 2007?

YES  NO

**DECLARATION BY APPLICANT OR AGENT ON BEHALF OF APPLICANT**

The contents of this Application are true to the best of my knowledge and belief.

Signature  \* (see note below)  
for PINSENT MASONS LLP

Date 14 March 2024

~~APPLICANT~~/ AGENT (delete as appropriate)

Telephone number and email address of signatory 0141 567 8636  
audrey.ferrie@pinsentmasons.com

I have enclosed the relevant documents with this application – please tick the relevant boxes

- Operating plan
- Layout plan (highlighting the area where alcohol is sold/consumed)
- Planning certificate
- Building standards certificate
- Food hygiene certificate

**\* Data Protection Act 2018**

The information on this form may be held on an electronic public register which may be available to members of the public on request.

## OPERATING PLAN

LICENSING (SCOTLAND) ACT 2005, SECTION 20(2)(B)(i)

**This application should only be completed by the Licence Holder  
of the appropriate Premises Licence or their Agent.**

### 1. STATEMENT REGARDING ALCOHOL BEING SOLD ON PREMISES/OFF PREMISES OR BOTH

**Name and Address of Premises** TESCO EXPRESS

UNIT 1, FUTURES WAY

WALLYFORD

**Post Code** EH21 8FF

- 1(a)** Will alcohol be sold for consumption solely ON the premises? YES  NO
- 1(b)** Will alcohol be sold for consumption solely OFF the premises? YES  NO
- 1(c)** Will alcohol be sold for consumption both ON and OFF the premises? YES  NO

**2. STATEMENT OF CORE TIMES WHEN ALCOHOL WILL BE SOLD FOR CONSUMPTION ON PREMISES**

DAY	ON CONSUMPTION	
	Opening time	Terminal Hour
Monday	N/A	N/A
Tuesday	N/A	N/A
Wednesday	N/A	N/A
Thursday	N/A	N/A
Friday	N/A	N/A
Saturday	N/A	N/A
Sunday	N/A	N/A

**3. STATEMENT OF CORE TIMES WHEN ALCOHOL WILL BE SOLD FOR CONSUMPTION OFF PREMISES**

DAY	OFF CONSUMPTION	
	Opening time	Terminal Hour
Monday	10.00	22.00
Tuesday	10.00	22.00
Wednesday	10.00	22.00
Thursday	10.00	22.00
Friday	10.00	22.00
Saturday	10.00	22.00
Sunday	10.00	22.00

#### 4. SEASONAL VARIATIONS

Does the applicant intend to operate according to seasonal demand?

YES  NO

\*If YES – provide details



**5. PLEASE INDICATE THE OTHER ACTIVITIES OR SERVICES THAT WILL BE PROVIDED ON THE PREMISES IN ADDITION TO SUPPLY OF ALCOHOL**

ACTIVITY	ACTIVITY PROVIDED? YES / NO	To be provided during core licenced hours. Please confirm YES / NO	Where activities are also to be provided outwith core licensed hours. Please confirm YES/NO
----------	--------------------------------	--	---

<b>5a.</b> Accommodation	NO	N/A	N/A
Conference facilities	NO	NO	NO
Restaurant facilities	NO	NO	NO
Bar meals	NO	NO	NO

Social functions including:

<b>5b.</b> Weddings, funerals, birthdays, retirements etc.	NO	NO	NO
Club or other group meetings etc.	NO	NO	NO

Entertainment, including:

<b>5c.</b> Recorded music – see 5(g)	YES	YES	YES
Live performances – see 5(g)	NO	NO	NO
Dance facilities	NO	NO	NO
Theatre	NO	NO	NO
Films	NO	NO	NO
Gaming	NO	NO	NO
Indoor/outdoor sports	NO	NO	NO
Televised sport	NO	NO	NO

<b>5d.</b> Outdoor drinking facilities	NO	NO	NO
--	----	----	----

<b>5e.</b> Adult Entertainment	NO	NO	NO
--------------------------------	----	----	----

Where you have answered YES in respect of any entry in column 4 above, please provide further details below.

Recorded background music may be provided both during and outwith core licensed hours.

**5(f) If you propose to provide any activities other than those listed in 5(a) – (e), please provide details or further information below.**

The sale of food, non-food items and other household goods; the provision of ancillary consumer services within and outwith licensed hours; home deliveries.

**5(g) Late night premises opening after 1.00am**

Where you have confirmed that you are providing live or recorded music, will the decibel level exceed 85dB? YES  NO

When fully occupied, are there likely to be more customers standing than seated? YES  NO

**6. ON-SALES ONLY - CHILDREN AND YOUNG PERSONS**

**6(a)** When alcohol is being sold for consumption on the premises will children or young persons be allowed entry? YES  NO

**6(b)** Where the answer to **6(a)** is YES provide statement of the TERMS under which they will be allowed entry

N/A

**6(c)** Provide statement regarding the AGES of children or young persons to be allowed entry

N/A

**6(d)** Provide statement regarding the TIMES during which children and young persons will be allowed entry

N/A

**6(e)** Provide statement regarding the PARTS of the premises to which children and young persons will be allowed entry

N/A

**7. CAPACITY OF PREMISES**

**What is the proposed capacity of the premises to which this application relates?**

Off-Sales - 30.8sqm

**8. PREMISES MANAGER**

**(NOTE: not required where application is for grant of provisional premises licence)**

Full Name TBA AT CONFIRMATION

Date of birth \_\_\_\_\_

Contact address \_\_\_\_\_

\_\_\_\_\_ Post Code \_\_\_\_\_

Tel. No. \_\_\_\_\_ Email address \_\_\_\_\_

**Personal licence**

Date of issue \_\_\_\_\_

Name of Licensing Board issuing \_\_\_\_\_

Reference no. of personal licence \_\_\_\_\_

**DECLARATION BY APPLICANT OR AGENT ON BEHALF OF APPLICANT**

**If signing on behalf of the applicant please state in what capacity.**

The contents of this operating plan are true to the best of my knowledge and belief

Signature  (\* see note below)  
for PINSENT MASONS LLP

Date 14 March 2024

Capacity ~~APPLICANT~~ / AGENT (delete as appropriate)

Tel. No. of signatory 0141 567 8636

Email address audrey.ferrie@pinsentmasons.com

**\* Data Protection Act 2018**

The information on this form may be held on an electronic public register which may be available to members of the public on request.



## SUPPLEMENTARY APPLICATION INFORMATION

This information is required in relation to all Premises Licence/Provisional Licence applications or any application which is a Premises Licence Variation, not considered to be a Minor Variation.

Application submissions generally tend to be insufficiently detailed as to provide a complete picture of what businesses propose to provide the public. Therefore, Licensing Boards often have too little information, in advance of Board hearings, to fully appreciate what is being applied for. This situation often leads to numerous unnecessary objections and representation being made due to interested parties, such as neighbouring residents, not understanding what proposed activities really relate to i.e. What does Live Music actually mean and how will it impact on their lives. For these reasons, the Board has made a policy decision to require applicants to provide a fuller description of their business proposals and detail how the five licensing objectives will be met.

## **BUSINESS PROFILE**

Please describe your business offering

Tesco is a large, national operator with a range of head office and local support. The company has devised policies, procedures, systems and training to ensure that they can sell alcohol in a responsible manner. There is a detailed staff training programme which ensures comprehensive training is provided to employees having regard to their role and the responsibilities and such training is regularly refreshed, and appropriate records kept.

Tesco supports the five licensing objectives. The practices adopted at the premises are consistent with these and a non-exhaustive list of them are noted below. Some of these practices fall under two or more objectives. Where this is the case, for the sake of brevity, we have sought to include them only under one heading.

## **ON CONSUMPTION**

(a) Please describe the type of business you intend to operate in respect of On consumption.

There is no intention to operate an On-Sales provision.

## **OFF CONSUMPTION**

(b) Please describe the type of business you intend to operate in respect of Off consumption & deliveries

The sale of alcoholic beverages in store and by home delivery.



**CLARIFICATION IS REQUIRED IN RELATION TO THE CONTENT OF YOUR PROPOSED OPERATING PLAN**

To what extent do you intend to use any of the following:  
Accommodation; Conference Facilities; Restaurant Facilities; Bar Meals:

There is no intention to use any of the above facilities.

**Social Functions** – Weddings; Birthdays; Retirements ; Other:

If you intend to provide for any of these functions please describe the nature and extent and likely frequency of each:

There is no intention to use any of the above facilities.

**Entertainment** – Recorded Music; Live Performances; Dance Facilities; Theatre; Films; Gaming; Indoor/outdoor sports; Televised Sport – If you intend to provide for any of these facilities please describe the nature and extent and likely frequency of each:

There is no intention to use any of the above facilities with the exception of background recorded music which will be provided both within and without core licensing times.

**Outdoor Drinking Facilities** – If you intend to provide outdoor drinking facilities please describe where and what the facilities will be used for. You will also be required to provide a statement in the objectives section how you intend to prevent public nuisance from use of such facilities:

There will not be any outdoor drinking facilities.

**Adult Entertainment** – If you intend to provide any entertainment of a sexual nature please state the type and likely frequency if use. Adult entertainment is any form of sexual stimulation and includes adult humour or explicit language. The Board will also expect you to address the objective of preventing harm to children and young persons:

There is no intention to provide any form of adult entertainment.

**Activities Outwith Licensed Core Hours** – In your Operating Plan, at 5(e), you should have given details of any activity that will be provided outwith core licensed hours. If you wish you can expand on your explanation here:

Background recorded music may be provided outwith core hours.

**Any Other Activities** – In your Operating Plan at 5(f) you should have given details of any other type of activity you are likely to cater for. It would be useful to give an indication of the extent and frequency of such events:

Extent and frequency of other activities detailed at Q5(f) of the Operating Plan would be at all times during store opening hours. The sale of alcohol via home delivery would only occur between 10am and 10pm.

**Children and Young Persons** – If you intend to provide access for children and young persons on the premises please provide details of what facilities you have on the premises in respect of different age groups. In addition, please state where and what baby changing facilities will be provided for children under five years.

Not applicable as there is no intention to provide On-Sales.

## LICENSING OBJECTIVES

Please provide details below of how you will ensure that the 5 Licensing Objectives are complied with. It may be helpful in answering this section if you refer to the East Lothian Council Licensing Board's 'Statement of Licensing Policy, which can be found at

[https://www.eastlothian.gov.uk/downloads/file/27884/statement\\_of\\_licensing\\_policy\\_2018-2023](https://www.eastlothian.gov.uk/downloads/file/27884/statement_of_licensing_policy_2018-2023)

### **Preventing Crime and Disorder**

The premises will have a digital CCTV system that covers many areas of the shop floor including the main area which will be used for the display of alcohol, checkouts and entrance/exit. The CCTV system will be operated in accordance with East Lothian Council's licensing objectives. The CCTV images will be of evidential standard and retained for a minimum of 31 days. CCTV will be made available to a Licensing Standards Officer or Police Constable on request in a suitable format. Our staff are trained in the use of the CCTV system.

The tills on the premises will be used for all sales of alcohol and remain maintained in working order and operational at all times. The tills will accurately record the date, time, type, and amount of each alcoholic product sold.

A member of the management team will be on the premises all the time the store is open, unless there are exceptional circumstances. This colleague will have responsibility for the premises and will be the initial point of contact for any issues that may arise.

We will take appropriate measures to prevent any crime and disorder that can impact a licensed premises.

### **Securing Public Safety:**

The applicant is aware of its responsibilities under health and safety legislation, and will ensure the safety of any person visiting, or working in the licensed premises. The applicant will take into consideration all relevant appropriate control measures to ensure public safety is considered.

### **Preventing Public Nuisance:**

The applicant is aware of the need to have regard to the surrounding area and needs of local residents and will take all the appropriate measures to ensure that employees are aware of this and in control of it too.

The applicant has a "good neighbour" ethos which seeks to ensure that the premises plays an active part in the local community.

### **Protecting and Improving Public Health:**

The applicant recognises the importance of having regard to protecting and improving public health. The applicant has a clear understanding of the offences in connection with the sale of alcohol to a person who appears drunk, or who is known to have consumed large quantities of alcohol and allowing drunkenness on the premises. The employees of the premises are also trained in this.

As stated in Tesco's statement on responsible retailing of alcohol, tobacco and other age-restricted products, the applicant has committed to increasing the range of low and mid range beers, lower alcohol wines and reducing the alcohol by volume of beer and cider where possible. The range of non-alcoholic or lower alcoholic spirits available will also continue to increase.

The applicant works closely with local authorities and police forces to address the issues of alcohol-related anti-social behaviour in or around Tesco stores.

### **Protecting Children and Young Persons From Harm:**

The premises will operate a Think 25 policy. As part of the underlying system, all checkouts will be programmed to prompt the staff member when an alcohol product is scanned to follow the policy. When any age restricted product is scanned, the checkout will freeze, preventing the transaction from proceeding, until the staff member makes a positive action on the checkout to clear the Think 25 prompt and proceed with the transaction.

The checkout prompt will also display the minimum date of birth a customer must have in order to be old enough to purchase the product. The staff member can reference this date therefore eliminating the need for any date of birth calculations when checking ID.

All colleagues will receive training in relation to the underlying law and Tesco policy, systems, and procedures. This training will be documented, and refresher training will be provided on a regular basis. The Think 25 policy is also applied to other restricted products as listed in the statement on responsible retailing of alcohol, tobacco and other age-restricted products such as tobacco, nicotine, butane, psychoactive substances, knives, scissors, lighters, lottery tickets and fireworks.

In the event that there are home deliveries, appropriately trained drivers will be used and the Think 25 policy will be applied.

**APPLICATION SUPPORTING COMMENTS**

**Additional Information**

**Supporting Comments**  
i.e. reasons why the Board should support your application.

**SIGNATURE AND DECLARATION BY APPLICANT**

**IT IS AN OFFENCE TO MAKE A FALSE STATEMENT IN OR IN CONNECTION WITH THIS APPLICATION**

(Criminal Law (Consolidation)(Scotland) Act 1995 Section 44(2)(b))

The contents of this Application are true to the best of my knowledge and belief.

Signature   
for PINSENT MASONS LLP

Date 14 March 2024

### Question 1

#### Disabled access and facilities

1(a)	Is there disabled access to the premises	YES
1(b)	Do you have facilities for those with a disability	YES
1(c)	Do you have any other provisions available to aid the use of the premises by disabled people	YES

If you have answered Yes to any of the questions above, please complete, as appropriate, the following sections: -

### Question 2

#### Disabled access to, from and within the premises

Please provide a clear and detailed description of how accessible the premises are for disabled people e.g., ramps, accessible floors, signage.

- **Tesco Detailed Access Guides:** We work with AccessAble to create full Access Guides for all UK stores, created by a trained surveyor according to ISO9001 standard. The Detailed Access Guide gives information specific to each store letting customers know what access will be like when they visit, with photos. It looks at the route customers will use getting in and what is available inside each store. We updated the guides all the time to make sure they are as accurate as possible.

More information can be found here: <https://www.accessable.co.uk/tesco>

- The entrance to the store is directly from Future Way and there is a ramp at the main doors to enable disabled access to the premises.
- The aisles are wide enough to allow disabled access around the store.
- Doors and emergency exits provide enough space for disabled people to enter and exit the premises.

### Question 3

#### Facilities available

Please describe in detail the facilities provided for disabled people e.g., disabled toilets, lifts, accessible tables.

- There is a unisex disabled toilet which is mainly for colleague use but will be offered to customers in the event of an emergency.

#### Question 4

##### Other provisions

Please provide details of any other provisions made to aid the use of the premises by disabled people e.g., assistance dogs welcome, large print menus.

- **Facilities for the hard of hearing:** Customers can look for signs with the “hearing loop ear” symbol. This is where our checkouts are fitted with an induction loops system to support customers and colleagues who may have hearing difficulties.
- **Assistance dogs:** Tesco welcome assistance dogs in all our stores.
- **Booking help in advance:** Aided or accompanied shops can be offered to customers who may have difficulty getting around the store or need additional support with their shopping.
- **Sunflower lanyard:** If a customer is wearing a Sunflower lanyard, colleagues will understand that they have a hidden disability and that they may need a little extra help or time during their shopping trip. Free Sunflower lanyards are available to customers and colleagues.
- **Larger text on self-service checkouts:** Customers can enlarge the text at the self-service checkouts using a touch button on the bottom right of the screen.
- **Shopping aids for autistic people:** Tesco has an autism-friendly visual guide to shopping and a PECs shopping list (Picture Exchange Communication System).
- **In-store quiet hours:** From 9-10am every Wednesday and Saturday, we have a quiet hour in all our stores.





LICENSING (SCOTLAND) ACT 2005  
TOWN AND COUNTRY PLANNING (SCOTLAND) ACT 1997

**SECTION 50  
PLANNING CERTIFICATE**

APPLICANT:	PTLL Limited
NAME AND ADDRESS OF PREMISES:	Tesco Express, Unit 1, Futures Way, Wallyford, EH21 8EF

**SECTION 50 PLANNING CERTIFICATE**

I confirm that planning permission (ref:.....) under the Town and Country Planning (Scotland) Act 1997 in respect of any development of the subject premises in connection with their proposed use as a licensed premises has been obtained.

I confirm that planning permission is not required.

**SECTION 50 PROVISIONAL PLANNING CERTIFICATE**

I confirm that planning permission (ref: 22/01374/AMC) has been obtained in respect of the construction or conversion of the subject premises.

I confirm that planning permission is not required.

I hereby confirm that, in terms the above Acts, I have no objections to the granting of the Confirmation of the Premises License to cover the above proposals.

Signed:		Date:	21 <sup>st</sup> February 2024
<b>Keith Dingwall Service Manager, Planning</b>			



REV #	DATE	AMENDMENTS
1	18.01.2024	TOTAL LISTING FOOTPRINTAGE 30 8 10 M

ADDRESS: NEW NEIGHBOURHOOD CENTRE, FUTURES WAY, WALLYFORD, EH21 8FF

- FIRE DETECTION LEGEND**
- SOUNDER
  - VISUAL INDICATOR (BEACON)
  - 5KG 27A FOAM & 2KG CO2 EXTINGUISHERS
  - AREA COVERED BY SMOKE DETECTION
  - BREAK GLASS CALL POINT

**Disclaimer:** Any information contained in this drawing which is not required by regulation 5 of SSI 2007 (AS2) is included for illustrative purposes only and does not form part of the layout plan for the purposes of the said regulation or the Licensing (Scotland) Act 2005

This will prevent us requiring a new application when other areas of the store change

CHILDREN AND YOUNG PERSONS ARE ALLOWED ACCESS THROUGHOUT THE PREMISES

AREA TO BE USED FOR THE DISPLAY OF ALCOHOL PRODUCTS PACKED WITH ALCOHOL AND NON-ALCOHOL DRINKS

PROJECT: WALLYFORD FUTURES WAY

DESCRIPTION: PROPOSED SITE BWS LICENSE LAYOUT

DRAWING NO: WALLYFORDFeaspg# #BWSPLAN

Phase: 2 ISSUE: ##

SYSTEM ID no: WALLYFORDFeaspg # dwg

DATE: 18.01.2024

FEASIBILITY MANAGER: JON WOODCOCK

TBS PLANNER: PRIYANKA

**FEASIBILITY PLANNING STORE PLANNING DEPARTMENT**  
PROPERTY SERVICES  
HIGHWOODS BUILDING, WESTRAL WAY  
WELWYN GARDEN CITY, HERTFORDSHIRE, AL7 1QB, UK  
TELEPHONE: 01298 361500

Category	Product / Type	Legislation / Code
Non Legislation Used	N/A	Fire Scotland Act 2012 2006
Building Scotland Regulations	N/A	Building Scotland Regulations 2004 and Scottish Building Standards Technical handbook, Non Domestic
Fire Extinguishers	Installed	Extinguishers shall be provided in accordance with requirements of BS 5034:1991, 1A, 1B & BS EN 3:2004
Fire Alarms	Installed	Extinguishers shall be provided in accordance with requirements of BS 5034:1991, 1A, 1B & BS EN 3:2004
Fire Alarms	Installed	Extinguishers shall be provided in accordance with requirements of BS 5034:1991, 1A, 1B & BS EN 3:2004
Smoke / Heat Extractors	Installed	As per requirements of building Scotland regulations, 2004 and Scottish Building Standards Technical handbook, Non Domestic
Drop Ceilings / Partitions	Fixed	Requirements of building Scotland regulations 2004 and Scottish Building Standards Technical handbook, Non Domestic
Sanitary systems	Installed	Requirements of building Scotland regulations 2004 and Scottish Building Standards Technical handbook, Non Domestic
Washbasins	N/A	Not legal in areas where members of the public can use them as a means of escape in the event of fire
Shower doors	N/A	Not legal in areas where members of the public can use them as a means of escape in the event of fire
Emergency lighting	N/A	As per Tesco design standards and to comply with requirements of building Scotland regulations, 2004 and Scottish building standards, standards BS 5266: Part 1:2005 and BS 5266: Part 2:2004
Construction walls	N/A	Constructed to meet with the requirements of building Scotland regulations 2004 and Scottish building standards, technical handbook, Non Domestic
Exit doors	N/A	Requirements of building Scotland regulations 2004 and Scottish building standards, technical handbook, Non Domestic
Direction signage	N/A	As per requirements of building Scotland regulations 2004 and Scottish building standards, technical handbook, Non Domestic
Break glass units	N/A	Locations at every door that can be used to access the building. Requirements of building Scotland regulations 2004 and Scottish building standards, technical handbook, Non Domestic

FUTURE WAY

TOTAL DEPTH OF STORE 31.98 M

TOTAL WIDTH OF STORE 23.20 M

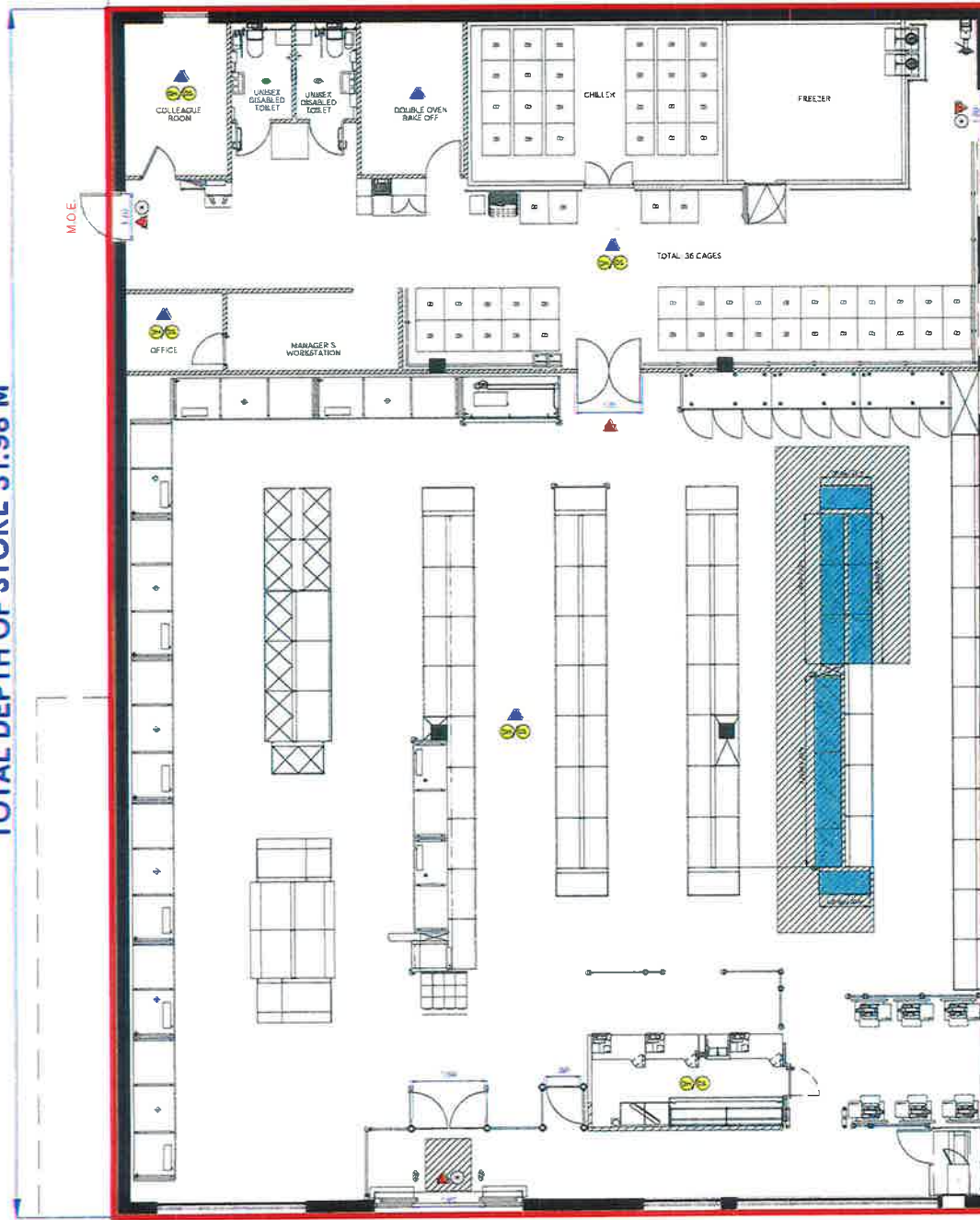

ENTRANCE

REV #	DATE	AMENDMENTS
1	18.01.2024	TOTAL LICENSED FLOORAGE 20.8 SQM

ADDRESS: NEW NEIGHBOURHOOD CENTRE, FUTURES WAY, WALLYFORD, EH21 8FF

**FIRE DETECTION LEGEND**

- SOUNDER
- VISUAL INDICATOR (BEACON)
- 8KG 27A FOAM & 2KG CO2 EXTINGUISHERS
- AREA COVERED BY SMOKE DETECTION
- BREAK-GLASS CALL POINT

Disclaimer: Any information contained in this drawing which is not required by regulation 5 of SSI 2007 / AS2 is included for illustrative purposes only and does not form part of the layout plan for the purposes of the same regulation or the licensing (Scotland) Act 2005. This will prevent us reusing a new application when other areas of the store change.

CHILDREN AND YOUNG PERSONS ARE ALLOWED ACCESS THROUGHOUT THE PREMISES

AREA TO BE USED FOR THE DISPLAY OF ALCOHOL; PRODUCTS PACKED WITH ALCOHOL AND NON-ALCOHOL DRINKS

PROJECT: WALLYFORD FUTURES WAY

DESCRIPTION: PROPOSED RETAIL BWS LICENSE LAYOUT

DRAWING NO: WALLYFORD/Flooring # BWSPLAN

PHASE	ISSUE	# #
1	1	1

SCALE: 1:125@A3 DATE: 18.01.2024

FEASIBILITY: JON MANAGER: WOODCOCK

TBS PLANNER: PRIYANKA

**TESCO**  
FEASIBILITY PLANNING  
STORE PLANNING DEPARTMENT  
PROPERTY SERVICES  
HIGHWOODS BUILDING, KESTRAL WAY  
WELYN GARDEN CITY, HERTFORDSHIRE, AL7 1GR UK  
TELEPHONE: 01767 891500  
WWW.TESCO.COM

Category	Installed / Type	Legislation / Code
Non-regulation Used	N/A	Fire Scotland Act 2006
Fire extinguishers	Installed	Building Scotland Regulations 2004 and Scottish Building Standards Technical Handbook: Non-Domestic
Fire blankets	N/A	Least with stores as per Tesco design standard. To comply with requirements of BS 5306 Pt 1 & 2 & BS EN 1869-1
Smoke / heat detectors	Installed	Location as per requirements of Building Scotland Regulations 2004 and Scottish Building Standards Technical Handbook: Non-Domestic. Fire alarm to be installed by / provided by BSE and tested against BS 5839-1:2002. Fire alarm to be installed by / provided by BSE and tested against BS 5839-1:2002.
Door (panic / egress)	Fixed	Requirements to building Scotland Regulations 2004 and Scottish Building Standards Technical Handbook: Non-Domestic. Construction to comply with BS 5839-1:2002 Pt 2 and BS EN 1869-1:2002.
Sprinkler systems	Installed	Installed under the requirements of Building Scotland Regulations 2004 and Scottish Building Standards Technical Handbook: Non-Domestic. Installation to comply with BS 5839-1:2002 Pt 2 and BS EN 1869-1:2002.
Highways	N/A	Not required as premises are not a means of escape in the event of fire.
Sliding doors	N/A	If doors on a means of escape route are of a slide to open nature then they have to comply with BS 5839-1:2002 Pt 2.
Emergency lighting	N/A	As per Tesco design standards and to comply with requirements of building Scotland Regulations 2004 and Scottish Building Standards.
Concoursement walk	N/A	Constructed to meet with the requirements of building Scotland Regulations 2004 and Scottish Building Standards Technical Handbook: Non-Domestic. Construction to comply with BS 5839-1:2002 Pt 2 and BS EN 1869-1:2002.
Exit doors	N/A	Requirements to building Scotland Regulations 2004 and Scottish Building Standards Technical Handbook: Non-Domestic. Construction to comply with BS 5839-1:2002 Pt 2 and BS EN 1869-1:2002.
Direction signage	N/A	Installed under the requirements of building Scotland Regulations 2004 and Scottish Building Standards Technical Handbook: Non-Domestic. Fire Scotland Act 2006 and BS 5839-1:2002 Pt 2.
Door glass units	N/A	Locations at every door that can be used to enter the building. Requirements of building Scotland Regulations 2004 and Scottish Building Standards Technical Handbook: Non-Domestic. Fire Scotland Act 2006.

**List of Directors – PTL Limited (08926930) as at 21 February 2024**

Name	Address	Date/Place of Birth	Position
MAJID, Kay Elizabeth	[REDACTED]		Director
WELCH, Robert John			Director
Tesco Services Limited			Director

# EAST LoTHIAN COUNCIL

## Licensing Standards

---

**From:** Licensing Standards Officer

**To:** C. Grilli  
Clerk to the Licensing Board

---

**Date:** 16<sup>th</sup> April 2024

**Subject:** LICENSING (SCOTLAND) ACT 2005

**PROVISIONAL PREMISES LICENCE APPLICATION**

**TESCO EXPRESS, UNIT 1, FUTURES WAY, WALLYFORD, EAST LoTHIAN EH21 8FF**

Section 45 (1) Licensing (Scotland) Act 2005 - A premises licence application may be made in relation to any premises despite the fact that, at the time the application is made, the premises are yet to be, or are in the course of being, constructed or converted for use as licensed premises.

This type of licence is considered for premises that are yet to be, or in the course of being, constructed or converted for use as a licensed premises. The premises is not yet constructed.

I can confirm that the application is compliant with the Act.

The off sales capacity applied for is 30.8 m<sup>2</sup>. Within an approx. 800m radius there are 3 other premises as follows:

- Wallyford Day to Day Supermarket, Salters Road – Off sale
- Wallyford Grocers, Salters Road – Off sales
- Wallyford Miners Welfare and Social Club, Salters Road – On and off sales

I recommend the following condition be considered in relation to deliveries of alcohol:

- 1) Should a service of delivery of alcohol to customers be conducted, the terms of the Licensing (Scotland) Act 2005 Section 119 and those of the Board's statement of licensing policy on deliveries of alcohol, should be complied with.

If successful in obtaining the provisional premises licence, the premises will be subject to a licensing inspection on the confirmation of the licence.

Licensing Standards Officer

16/04/2024

Your Ref: EL403  
Our Ref: 809249

The Clerk of the Licensing  
Board  
East Lothian Council  
John Muir House  
Haddington  
East Lothian  
EH41 3HA



**POLICE  
SCOTLAND**

Keeping people safe

Catriona Paton  
Chief Superintendent  
Divisional Commander  
The Lothians and Scottish Borders Division  
Dalkeith Police Station  
Newbattle Road  
Dalkeith, EH22 3AX

Dear Sir/Madam,

**LICENSING (SCOTLAND) ACT 2005 - APPLICATION FOR THE GRANT OF A  
PREMISES LICENCE  
TESCO EXPRESS  
UNIT 1, FUTURES WAY, WALLYFORD, EH21 8FF.**

I refer to the above application and in terms of Section 21(4)(a)(i) and (ii) of the Licensing (Scotland) Act 2005, I have to advise you that neither the applicant nor any connected person has been convicted of any relevant offence.

I am unable to confirm the existence of any foreign offence in respect of the applicant or any connected person.

Yours faithfully

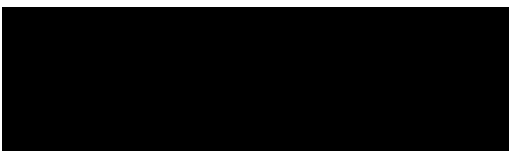

Catriona Paton  
Chief Superintendent

For enquiries please contact the Licensing Department on 0131 654 5583.



## Licensing

---

**From:** Robertson, Scott  
**Sent:** 04 April 2024 14:37  
**To:** Licensing  
**Subject:** RE: Attached Image - Provisional Premises Licence for Tesco Express, Unit 1 Futures Way, Wallyford, EH21 8FF

Hello,

I have no comments or objections to this licence.

Regards  
Scott

-----Original Message-----

**From:** Licensing <licensing@eastlothian.gov.uk>  
**Sent:** Thursday, March 21, 2024 11:07 AM  
**To:** 'LothianScotBordersLicensingEastMid@Scotland.police.uk'; Licensing Standards Officer <lso@eastlothian.gov.uk>; Environment Reception <environment@eastlothian.gov.uk>; Environmental Health/Trading Standards <ehts@eastlothian.gov.uk>; torquil.cramer@firescotland.gov.uk; licensing@nhslothian.scot.nhs.uk; info@wallyfordcommunitycouncil.com  
**Subject:** FW: Attached Image - Provisional Premises Licence for Tesco Express, Unit 1 Futures Way, Wallyford, EH21 8FF

Hi

Please find attached Provisional application for Tesco Express, Wallyford for report/representation by 18th April, 2024.

Kind regards

Gillian

Gillian Herkes  
Licensing Officer  
Democratic & Licensing Services  
John Muir House  
Haddington  
East Lothian Council  
01620 820114  
gherkes@eastlothian.gov.uk

-----Original Message-----

**From:** "Herkes, Gillian" <gherkes@eastlothian.gov.uk>  
**Sent:** Thursday, March 21, 2024 10:31 AM  
**To:** Herkes, Gillian <gherkes@eastlothian.gov.uk>  
**Subject:** Attached Image

CAUTION: This email originated from outside of the organisation. Do not click links or open attachments unless you recognise the sender and know the content is safe.

## Licensing

---

**From:** Muir, Marion  
**Sent:** 26 March 2024 16:08  
**To:** Licensing  
**Cc:** Douglas, Andrew; Wemyss, Laura  
**Subject:** FW: Attached Image - Provisional Premises Licence for Tesco Express, Unit 1 Futures Way, Wallyford, EH21 8FF  
**Attachments:** Herkes\_ Gillian\_XVF20528\_FIREBIRD\_3010\_001.pdf; FW: Attached Image - Provisional Premises Licence for Tesco Express, Unit 1 Futures Way, Wallyford, EH21 8FF  
**Follow Up Flag:** Follow up  
**Flag Status:** Flagged

Gillian/Licensing

I note that the premises has yet to be built and would advise that the applicant has not yet registered as a Food Business with this department (this should be submitted at least 28 days prior to the business starting). I would ask for the contact details in order that I can contact the Agent/Applicant re registration.

On the basis that the business register as required, I would advise that this office has no objections to the application in principle, but will require more information going forward in relation to the internal layout-sins/wash hand basins/finishes etc.

I have also attached herewith an email which includes an email from The Corporate Address Gazetteer (CAG) which includes " I would suggest that Tesco's are contacted stating that they need to apply for an address for the new store to be added to the Address Gazetteer etc, before they can apply for provisional licenses etc as Unit 1 Futures Way does not exist. It is likely that this address may change depending on where the main access to the store is (which street) and a new street may also be required."

Best regards

Marion

Marion Muir, Business Compliance- Environmental Health, East Lothian Council  
01620 827234/07990 540729

-----Original Message-----

**From:** Environmental Health/Trading Standards <ehts@eastlothian.gov.uk>  
**Sent:** Thursday, March 21, 2024, 1:49 PM  
**To:** Douglas, Andrew <adouglas@eastlothian.gov.uk>  
**Subject:** FW: Attached Image - Provisional Premises Licence for Tesco Express, Unit 1 Futures Way, Wallyford, EH21 8FF

-----Original Message-----

**From:** Licensing <licensing@eastlothian.gov.uk>  
**Sent:** Thursday, March 21, 2024 11:07 AM  
**To:** 'LothianScotBordersLicensingEastMid@Scotland.police.uk'; Licensing Standards Officer <Iso@eastlothian.gov.uk>; Environment Reception <environment@eastlothian.gov.uk>; Environmental Health/Trading Standards <ehts@eastlothian.gov.uk>; torquil.cramer@firescotland.gov.uk; licensing@nhslothian.scot.nhs.uk; info@wallyfordcommunitycouncil.com