

**PLAN**  
 SCALE (A1) 1:500  
 SCALE (A3) 1:1000

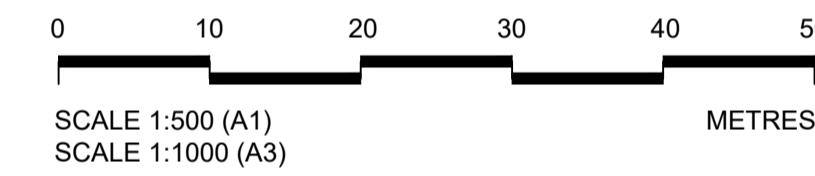

**KEY MAP**



**GENERAL NOTES**

1. ALL DIMENSIONS ARE IN METRES UNLESS NOTED OTHERWISE.
2. ALL LEVELS ARE IN METRES RELATIVE TO ORDINANCE DATUM NEWLYN (MAOD) UNLESS NOTED OTHERWISE.
3. DO NOT SCALE FROM THIS DRAWING.
4. THIS PLAN IS PROVIDED IN ACCORDANCE WITH THE REQUIREMENTS OF THE FLOOD RISK MANAGEMENT (SCOTLAND) ACT 2009 SECTION 60 AND SCHEDULE 2.
5. THE FLOOD PROTECTION OPERATIONS DETAILED ON THIS PLAN ARE FULLY DESCRIBED IN THE ACCOMPANYING FLOOD PROTECTION SCHEME OPERATIONS DOCUMENT (701909-JEC-S4-ZZZ-XXX-RE-C-0001).
6. SUPPLEMENTARY INFORMATION IS INCLUDED IN THE ACCOMPANYING EIA REPORT.
7. ANY DISTURBED GROUND TO BE REINSTATED. LANDSCAPING PROPOSALS TO BE AGREED WITH THE LOCAL AUTHORITY
8. VEGETATION OMITTED FOR CLARITY
9. INDICATION OF A PERSON REPRESENTS SOMEONE WHO IS 1.6M TALL
10. CHAINAGE REFERS TO THE DISTANCE ALONG THE FLOOD DEFENCE ALIGNMENT FOR A GIVEN WORK SECTION
11. AEP (ANNUAL EXCEEDANCE PROBABILITY) IS THE PROBABILITY OF A FLOOD EVENT OCCURRING IN ANY GIVEN YEAR

**LEGEND**

- Limit of land upon which entry is required for the purpose of carrying out the operations and execution of temporary works
- Proposed flood defence embankment
- Proposed flood defence wall
- Proposed flood gate
- Presumed active travel route
- Proposed pedestrian footpath
- Proposed bridge and ramp
- Trees and wooded area to be retained where possible
- Trees and wooded area to be removed
- Existing building structure
- Existing watercourse
- Existing road or footpath
- Structure to be demolished

P01	FIRST ISSUE	11/01/2024	LK	EM	JB	KN
Rev.	Description	Date	Author	Checker	Reviewer	Approver
Document Control						

Supplier

# Jacobs.

Project Title

## MUSSELBURGH FLOOD PROTECTION SCHEME

Drawing Title

### OUTLINE DESIGN WORK SECTION 30 EDGELAW RESERVOIR

Client

Originator <b>LK</b>	Checker <b>EM</b>	Reviewer <b>JB</b>	Approver <b>KN</b>
Suitability <b>S3 - SUITABLE FOR REVIEW &amp; COMMENT</b>			Status <b>S3</b>
Drawing number <b>701909-JEC-S4-W30-XXX-DR-Z-0001</b>			Revision <b>P01</b>
Scale <b>1:500</b>			





PLAN  
 SCALE (A1) 1:500  
 SCALE (A3) 1:1000

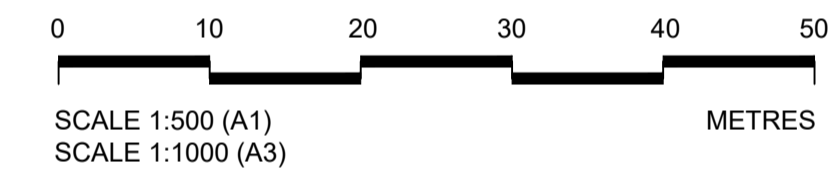

KEY MAP



GENERAL NOTES

- ALL DIMENSIONS ARE IN METRES UNLESS NOTED OTHERWISE.
- ALL LEVELS ARE IN METRES RELATIVE TO ORDINANCE DATUM NEWLYN (MAOD) UNLESS NOTED OTHERWISE.
- DO NOT SCALE FROM THIS DRAWING.
- THIS PLAN IS PROVIDED IN ACCORDANCE WITH THE REQUIREMENTS OF THE FLOOD RISK MANAGEMENT (SCOTLAND) ACT 2009 SECTION 60 AND SCHEDULE 2.
- THE FLOOD PROTECTION OPERATIONS DETAILED ON THIS PLAN ARE FULLY DESCRIBED IN THE ACCOMPANYING FLOOD PROTECTION SCHEME OPERATIONS DOCUMENT (701909-JEC-S4-ZZZ-XXX-RE-C-0001).
- SUPPLEMENTARY INFORMATION IS INCLUDED IN THE ACCOMPANYING EIA REPORT.
- ANY DISTURBED GROUND TO BE REINSTATED. LANDSCAPING PROPOSALS TO BE AGREED WITH THE LOCAL AUTHORITY
- VEGETATION OMITTED FOR CLARITY
- INDICATION OF A PERSON REPRESENTS SOMEONE WHO IS 1.6M TALL
- CHAINAGE REFERS TO THE DISTANCE ALONG THE FLOOD DEFENCE ALIGNMENT FOR A GIVEN WORK SECTION
- AEP (ANNUAL EXCEEDANCE PROBABILITY) IS THE PROBABILITY OF A FLOOD EVENT OCCURRING IN ANY GIVEN YEAR

LEGEND

- Limit of land upon which entry is required for the purpose of carrying out the operations and execution of temporary works
- Proposed flood defence embankment
- Proposed flood defence wall
- Proposed flood gate
- Presumed active travel route
- Proposed pedestrian footpath
- Proposed bridge and ramp
- Trees and wooded area to be retained where possible
- Trees and wooded area to be removed
- Existing building structure
- Existing watercourse
- Existing road or footpath
- Structure to be demolished

P01	FIRST ISSUE	11/01/2024	LK	EM	JB	KN
Rev.	Description	Date	Author	Checker	Reviewer	Approver

Document Control

Supplier

**Jacobs.**

Project Title  
**MUSSELBURGH FLOOD PROTECTION SCHEME**

Drawing Title  
**OUTLINE DESIGN WORK SECTION 31 RESEBERRY RESERVOIR**

Client

Originator <b>LK</b>	Checker <b>EM</b>	Reviewer <b>JB</b>	Approver <b>KN</b>
Suitability <b>S3 - SUITABLE FOR REVIEW &amp; COMMENT</b>	Status <b>S3</b>	Revision <b>P01</b>	
Drawing number <b>701909-JEC-S4-W31-XXX-DR-Z-0001</b>	Scale <b>1:500</b>		



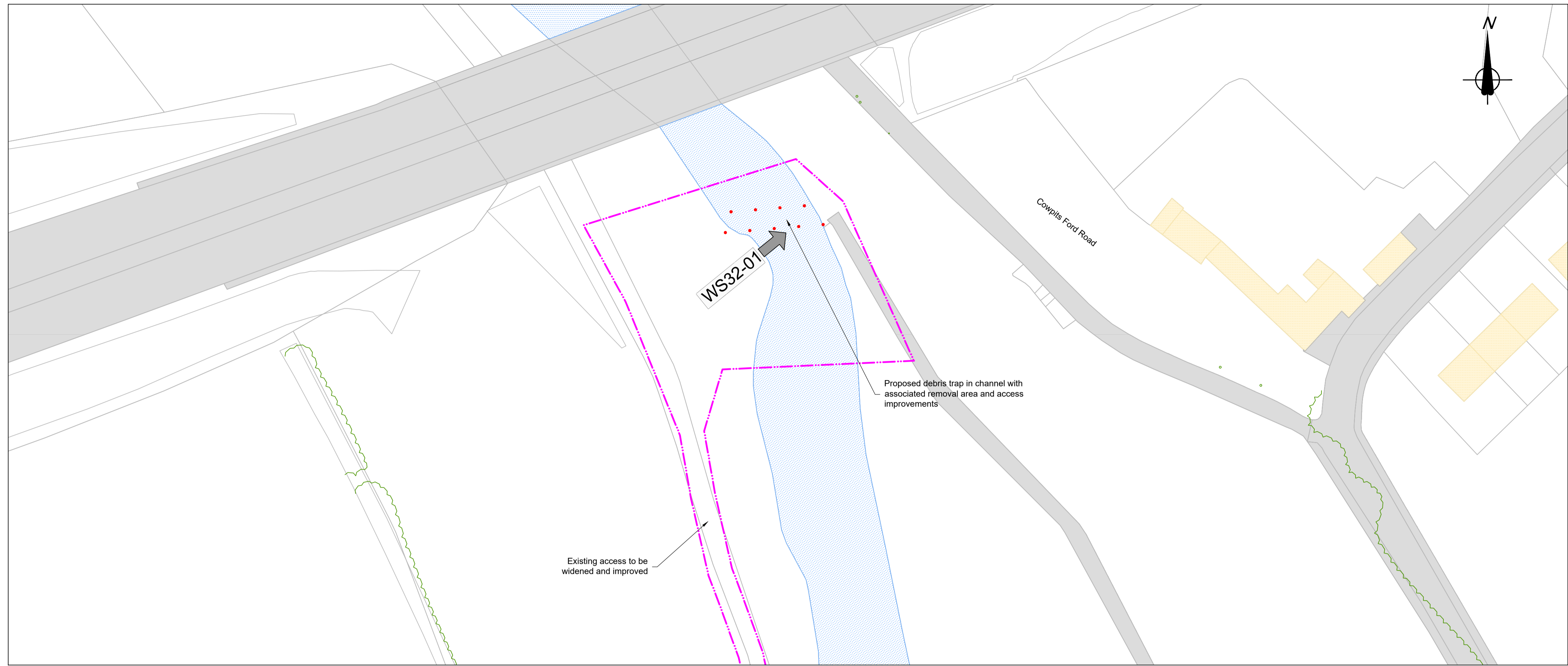

PLAN  
SCALE (A1) 1:500  
SCALE (A3) 1:1000

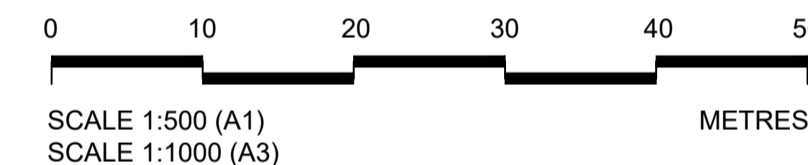

KEY MAP



GENERAL NOTES

1. ALL DIMENSIONS ARE IN METRES UNLESS NOTED OTHERWISE.
2. ALL LEVELS ARE IN METRES RELATIVE TO ORDNANCE DATUM NEWLYN (MAOD) UNLESS NOTED OTHERWISE.
3. DO NOT SCALE FROM THIS DRAWING.
4. THIS PLAN IS PROVIDED IN ACCORDANCE WITH THE REQUIREMENTS OF THE FLOOD RISK MANAGEMENT (SCOTLAND) ACT 2009 SECTION 60 AND SCHEDULE 2.
5. THE FLOOD PROTECTION OPERATIONS DETAILED ON THIS PLAN ARE FULLY DESCRIBED IN THE ACCOMPANYING FLOOD PROTECTION SCHEME OPERATIONS DOCUMENT (701909-JEC-S4-ZZZ-XXX-RE-C-0001).
6. SUPPLEMENTARY INFORMATION IS INCLUDED IN THE ACCOMPANYING EIA REPORT.
7. ANY DISTURBED GROUND TO BE REINSTATED. LANDSCAPING PROPOSALS TO BE AGREED WITH THE LOCAL AUTHORITY
8. VEGETATION OMITTED FOR CLARITY
9. INDICATION OF A PERSON REPRESENTS SOMEONE WHO IS 1.6M TALL
10. CHAINAGE REFERS TO THE DISTANCE ALONG THE FLOOD DEFENCE ALIGNMENT FOR A GIVEN WORK SECTION
11. AEP (ANNUAL EXCEEDANCE PROBABILITY) IS THE PROBABILITY OF A FLOOD EVENT OCCURRING IN ANY GIVEN YEAR

LEGEND

- Limit of land upon which entry is required for the purpose of carrying out the operations and execution of temporary works
- Proposed flood defence embankment
- Proposed flood defence wall
- Proposed flood gate
- Presumed active travel route
- Proposed pedestrian footpath
- Proposed bridge and ramp
- Trees and wooded area to be retained where possible
- Trees and wooded area to be removed
- Existing building structure
- Existing watercourse
- Existing road or footpath
- Structure to be demolished

P01	FIRST ISSUE	11/01/2024	LK	EM	JB	KN
Rev.	Description	Date	Author	Checker	Reviewer	Approver

Document Control

Supplier

**Jacobs.**

Project Title  
**MUSSELBURGH FLOOD PROTECTION SCHEME**

Drawing Title  
**OUTLINE DESIGN WORK SECTION 32**



Originator <b>LK</b>	Checker <b>EM</b>	Reviewer <b>JB</b>	Approver <b>KN</b>
Suitability <b>S3 - SUITABLE FOR REVIEW &amp; COMMENT</b>	Status <b>S3</b>	Revision <b>P01</b>	
Drawing number <b>701909-JEC-S4-W32-XXX-DR-Z-0001</b>	Scale <b>1:500</b>		