

## Members' Library Service Request Form

Date of Document	05/06/23
Originator	Graeme Marsden
Originator's Ref (if any)	
Document Title	Feasibility Study for National Climate Change Centre at Cockenzie - Concept and Programme

Please indicate if access to the document is to be “unrestricted” or “restricted”, with regard to the terms of the Local Government (Access to Information) Act 1985.

Unrestricted	<input checked="" type="checkbox"/>	Restricted	<input type="checkbox"/>
--------------	-------------------------------------	------------	--------------------------

If the document is “restricted”, please state on what grounds (click on grey area for drop-down menu):

For Publication
-----------------

Additional information:

Authorised By	Douglas Proudfoot
Designation	Exec Dir for Place
Date	06/06/23

For Office Use Only:	
Library Reference	50/23
Date Received	06/06/23
Bulletin	Jun 23





- 1 **360 Centre:** initial proposed site - building to potentially act as a hub to linked, satellite campuses across the wider site with different key foci
- 2 **Cafe terrace** overlooking sea
- 3 **Low level grasses** to form perimeter between site and John Muir Way
- 4 **Festival/ market/ event space** in courtyards focused around statue
- 5 **Nationally significant sculptures** positioned on footprint of old power station chimneys
- 6 **Play fountains** referencing site cooling system of past and the power of water in energy generation
- 7 **Low-level planters** with integrated seating
- 8 **Bike Store** made from recycled wind turbine
- 9 **Picnic area**
- 10 **Native planting**
- 11 **Play Area** with equipment made from recycled wind turbines
- 12 **Biodiversity & Birdwatching quiet area**
- 13 **Bird nesting/ nature wall** on footprint of former power station building
- 14 **Sustainable energy natural play / education area** incorporating water channel to reference water cooling system alongside play/education re. energy generation from water and other renewable sources
- 15 **Potential development area** for associated ventures to follow footprint of former power station and aid historic interpretation of site- e.g. Renewable energy training centre
- 16 **New path** created to follow historic line of coast prior to construction of power station to aid historic interpretation and help divide activity across site
- 17 **Car park** with entrance and width to reference footprint of power station
- 18 **Planting** to shield views to adjacent energy transformer site
- 19 **Pergola** covered route to form axis to new visitor centre and encourage biodiversity through planting
- 20 **Proposed road** to be extended as necessary to serve development
- 21 **Energy Park** on partial footprint of power station - a sculptural walk which charts the historic development of energy production - and the rise and decline of the focus on fossil fuels.

--- Historic line of coast prior to construction of power station shown red

SK 001.1 HIGH LEVEL CONCEPT  
SCALE: 1:1500 @ A1, 1:3000 @ A3

**Hiraeth.** 2228 SK001 Rev.  
**360 CENTRE**  
 SKETCH  
**High Level Concept**  
 Scale 1:1500 @ A1 Date 05/23  
 02920 025814 | office@hiraetharchitecture.co.uk  
 The Maltings | East Tyndall St | Cardiff | CF24 5EA

do not scale from this drawing | all dimensions to be verified on site | notify architect of all discrepancies | copyright Hiraeth architecture

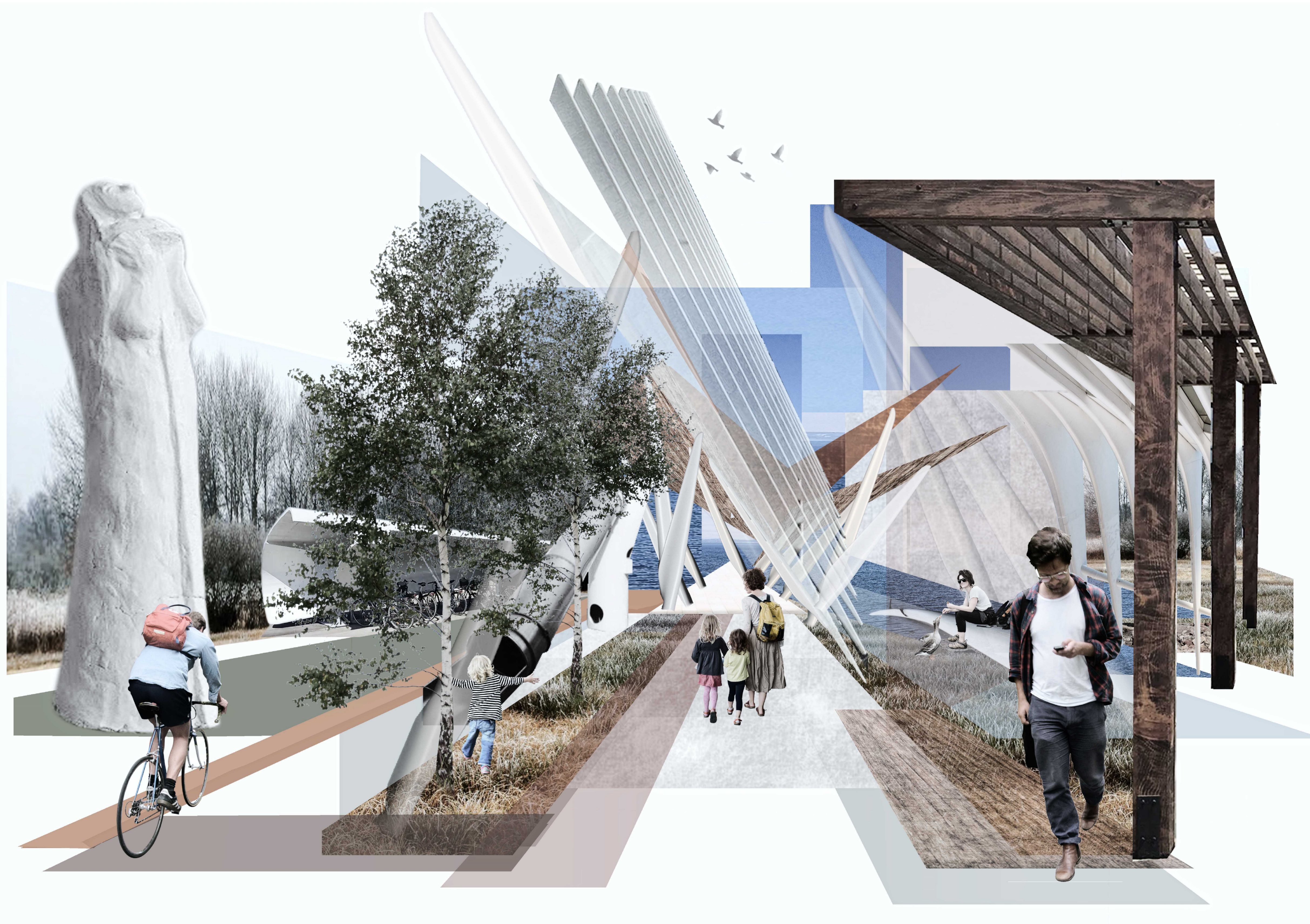

SK 002.1 CONCEPTUAL COLLAGE  
SCALE: NTS

**Hiraeth.** 2228 SK002 Rev.  
360 CENTRE  
SKETCH  
**Conceptual Collage**  
Scale NTS Date 05/23  
02920 025814 | office@hiraetharchitecture.co.uk  
The Maltings | East Tyndall St | Cardiff | CF24 5EA

do not scale from this drawing | all dimensions to be verified on site | copyright Hiraeth Architecture

**Key assumptions:**

Site is secured and remedial works carried out (Levelling Up Funding)

Partnership agreement secured

Project funding is in place

ACTIVITY	PLAN START	PLAN DURATION	Year One												Year Two												Year Three															
			1	2	3	4	5	6	7	8	9	10	11	12	13	14	15	16	17	18	19	20	21	22	23	24	25	26	27	28	29	30	31	32	33	34	35	36				
Stage One: Preliminary Design (Project Team appointed)	1	6	█																																							
Stage Two: Detailed Design*	6	12					█																																			
Stage Three: Tender Preparation, Issue, Evaluation and Award	17	6																█																								
Stage Four: Contract Management and Construction (including fitout)	22	14																					█																			
Stage Five: Project Handover	35	2																																			█					
Stage Six: Implementation and Operation (recruitment, training, marketing and soft opening)	25	12																							█																	

\*Planning secured without major conditions to discharge