

## Members' Library Service Request Form

Date of Document	01/06/22
Originator	Douglas Proudfoot
Originator's Ref (if any)	
Document Title	East Linton Primary School

Please indicate if access to the document is to be “unrestricted” or “restricted”, with regard to the terms of the Local Government (Access to Information) Act 1985.

Unrestricted	<input checked="" type="checkbox"/>	Restricted	<input type="checkbox"/>
--------------	-------------------------------------	------------	--------------------------

If the document is “restricted”, please state on what grounds (click on grey area for drop-down menu):

For Publication
-----------------

Additional information:

Authorised By	Douglas Proudfoot
Designation	Executive Director for Place
Date	01/06/22

For Office Use Only:	
Library Reference	75/22
Date Received	01/06/22
Bulletin	Jun22

**REPORT TO:** Members' Library Service  
**MEETING DATE:** June 2022  
**BY:** Executive Director for Place  
**SUBJECT:** East Linton Primary School

---



## **1 PURPOSE**

- 1.1 On 14 December 2021, East Lothian Council approved an alternative policy position, subject to public consultation and clarity on technical and financial feasibility, to deliver a replacement school in East Linton.
- 1.2 Since then officers have undertaken a public consultation on the potential layouts and siting of the replacement school and have identified a preferred layout for the school as a result. This report updates members on progress that has been made.

## **2 RECOMMENDATIONS**

- 2.1 Members are asked to note that the following progress has been made on the replacement school project since December 2021:
  - Public consultation ran through February 2022 on the replacement school and the three outline layouts set out in the December report – details set out below;
  - Consultation feedback indicated that layout A was most preferred and has been subject to further refinement based on consultation responses. These seek to reduce the footprint of the replacement school to within land identified for education purposes (Myra's Field) and to minimise impact on Memorial Park (3.10);
  - A full consultation analysis including those from groups and organisations, the public and school pupils is set out in Appendix 1; and
  - Following the determination of replacement school layout, a masterplan of the park encompassing the re-provision elements will be undertaken involving further engagement with stakeholders and the public (3.6 bullet No. 6, 3.11).
- 2.2 Members are asked to note that the following next steps will now be progressed in the context of the school replacement:

- The project will be taken forward as part of Learning Estate Review process with a report on that due in Autumn 2022;
- Council will seek to submit a bid for Scottish Futures Trust (SFT) funding towards the replacement school in Autumn 2022; and
- Further technical work will look to refine the scale and form of the school building that will result in a detailed planning application and park layouts including the provision and location of replacement community facilities. These will be subject to further public engagement and consultation in due time once further technical work has been completed.

### **3 BACKGROUND**

- 3.1 Full details of the background to the current school condition and what was reported to Council are available in the December 14 2021 Council report which is available as a Background Paper.

#### Consultation Events

- 3.2 Following the decision of Council on 14 December, officers prepared a consultation strategy for a public consultation on the proposed school layouts A, B and C that were part of the Council report. It was determined that this would be for a full calendar month of February and that as part of that, officers would virtually attend meetings of the East Linton Primary Parent Council and Dunpender Community Council to answer any questions that those organisations had. These events took place on 27 January and 3 February respectively. Details are available in Appendix 1. Officers from Sport, Countryside & Leisure have engaged with sporting groups currently using the park including East Linton Tennis Club and East Linton Football club to share the consultation information and seek initial feedback. Consultation information was also shared with local sustainability group Climate Action East Linton.
- 3.3 Due to the increasing COVID-19 case numbers it was felt that a public indoor town hall style event would not be suitable and instead officers presented at an outdoor drop in event at a stall at the Mart in East Linton on Saturday 12 February from 9am to 2pm. This allowed officers to engage with small groups and individuals and answer any questions attendees had whilst promoting the consultation portal and emphasising the importance of submitting a response. Details of consultation events are available in Appendix 1.

#### Online Consultation

- 3.4 A public consultation was set up on the East Lothian consultation portal alongside a dedicated webpage on the Council website with the Council report and the three layouts available. This set out a series of questions on which we were looking for feedback under four categories. These were:

- their priorities to help us create a new primary school that is fit for modern learning;
- their views on potential layouts that have been designed;
- their perspectives on the open green space and built facilities at Memorial Park; and
- options for community facilities and wider benefits.

3.5 The following online and offline communications channels were used to maximise awareness of, and engagement with, the consultation:

- Posters on bus stops and distributed to businesses within the village for display during the consultation period. The posters contained a QR code directing to the website to make it easy for people to engage;
- A banner on the school's railings to advise of the consultation and the Mart drop-in session;
- Information provided to the school for its own newsletter;
- Two press releases and images shared with media; these were both covered in the East Lothian Courier in print and online; and
- Information shared on the council's own twitter and facebook channels throughout the period.

#### Consultation Responses & Analysis

3.6 The Council received 72 responses on the portal as well as ten emails, one letter and the minutes of East Linton Tennis Club. Special consultation forms were also received from each year group in the primary school. Seventy-nine of the responses were from individuals and four responses were from the following organisations:

- Dunder Community Council
- East Linton PS Parent Council
- Climate Action East Linton
- East Linton After School Club

3.7 A full consultation analysis is available in Appendix 1. However, the following main points can be drawn:

- It is clear in almost all responses that the wider park area is valued and is important to residents as the only central green space within the village. It is well used for a variety of recreation purposes and the impact of any proposal should be minimised;

- The majority of respondents see the benefits of replacing the school with a modern, safe facility which creates a better learning environment, for which there is potential shared use of facilities outside core school hours;
- Layout A is the preferred option by the majority of respondents who responded to that question, although a significant number of responses would prefer not to see Myra's Field (Education Land) or Memorial Park developed and either a new site selected on the edge of town or the school rebuilt on the existing site;
- Layouts B and C received significantly less support on the basis that they would have greater impact on the form and function of Memorial Park;
- Sustainability in the design, layout, construction and layout of the school is an important consideration, as is the use of natural materials;
- Redesign of the park space and corresponding facilities will be critical and will require further technical work and consultation with groups;
- Concern over impact on established trees within the park was raised by some; and
- Parking and access to the school is a significant issue with some raising concern over impacts of lack of school parking and drop off on surrounding streets. However, others praised the central location and that Council should promote active travel for pupils and staff and should not be encouraging parking and drop off.

3.8 Whilst no group or individual carries more importance than another it is also appropriate to set out a summary of the response from Dunder Community Council as a representative body. The key points are:

- Overall supportive of delivery of a replacement school with modern, flexible use facilities and a bigger playground. Have indicated a preference for Layout A but with caveats;
- Support community use of facilities due to village hall pressures. Need for use by before and after school clubs;
- Support a number of sustainable design measures, including the use of renewable technologies;
- Layout A minimises impact on park although Council should acquire land adjoining town for sports and recreation;
- All elements of park are well used and should be replaced. Should not be a period where facilities are not provided; and

- Would have liked for a non-park layout option but understood reasons why this was not possible.

### Responding to the Consultation & Next Steps

- 3.9 The overall quality of responses was very high and many were significantly detailed with nuanced points. That cannot be briefly summarised here or even in the accompanying appendix and therefore officers working on the project have been making themselves familiar with all the responses to inform the next technical steps of the project and the re-design of the park and its facilities.
- 3.10 In terms of school layout, as it was the most preferred, officers are progressing with Layout A. Officers agree with the majority of responses that it is layout A that retains the most coherence of the existing park and has the school being laid out on majority land allocated for education use (set out in December 2021 Council report). Layouts B and C could significantly impact or even prevent the use of the park for the annual Gala and other formal events.
- 3.11 The Council does recognise the strength of the responses regarding the importance of the park as an open, accessible green space and therefore there is a need to minimise the impact of the replacement school on the park but whilst also meeting statutory requirements of a new school building and premises. For that reason, as part of the ongoing technical work into the replacement school, the footprint of the building will be adjusted and the playground area redesigned so that the area of the new school site is located within the land allocated for education use in the 2018 Adopted Local Development Plan.
- 3.12 The responses strengthen the importance of re-providing quality sports and recreation facilities within the park. These include the play park, skate park, tennis courts, football pitch, changing pavilion and toilets. The need to ensure space remains for open green space that supports informal use of the park is also noted. Further technical work looking at options of where these would be relocated and in what format is required as well as wider planting, landscaping and footpaths within the park.
- 3.13 Masterplanning the re-provision of facilities within the park will be subject to significant study and technical analysis given the potential impact on mature trees and the strength of often opposing opinions on parking and access to the school. It should be noted that a new car park will be provided nearby at the station.
- 3.14 A number of responses states that an alternative non-park or education land (Myra's Field) site should be found instead or the school rebuilt on the existing site to prevent the loss of any green space. However, as set out in the December Council report, these options are not possible for delivering a replacement school in reasonable timescales and cost for the following reasons:

- The Council has no alternative land ownership in East Linton for the provision of the primary school and Myra's field is allocated for education use in the 2018 Adopted Local Development Plan. Any alternative site could take a number of years to allocate and purchased through a legally compliant planning and procurement exercise and therefore would not deliver additional capacity to deal with the expected increase in capacity required for 2024.
- The existing school site within its current walled playground is too small to accommodate a modern school and playground with a quality learning environment. The school area would have to expand into the neighbouring education land (Myra's Field) impacting on the provision of green space and the football pitch and requiring path alignments to be changed.
- Rebuilding the school on the existing site would mean that temporary capacity would need to be provided for the entire school during at least a two year period to allow for demolition, refurbishment and construction of the new school. None of the nearby primary schools have sufficient spare capacity to host this level of pupils and early learning and childcare places. Therefore the Council would have to procure an entire nine class primary school in temporary units (including nursery and hall units) and locate these within the park and Myra's Field whilst construction was underway. These would have significant revenue costs implications and would require foundations and utilities installation, causing significant damage to the park in the process.

#### **4 POLICY IMPLICATIONS**

- 4.1 A replacement school will require a planning application to be submitted and any such application would require to be assessed against relevant policies of the ELLDP2018.

#### **5 INTEGRATED IMPACT ASSESSMENT**

- 5.1 It is not possible to undertake an integrated impact assessment on the replacement school until further technical and feasibility work is completed. An assessment will be made available at that stage should that be required.

#### **6 RESOURCE IMPLICATIONS**

- 6.1 Financial – Following the December 2021 Council Report, in March 2022 Council approved the capital budget which included an allowance of £11M for a replacement school at East Linton. This was based on potential costs of a school with that roll and not a detailed cost proposal breakdown on a

bespoke school design. The capital budget also included an allowance for £1.5M expenditure on park re-design and the re-provision of community facilities.

- 6.2 A final decision on a new replacement school is based on being awarded SFT funding for the school and the Council intends to submit a funding bid in Autumn 2022. Note that SFT funding is revenue support for up to 50% of the cost of replacing the existing school and is paid over a 25 year period.
- 6.3 Personnel – As with the Integrated Impact Assessment, this will not be possible to estimate until the technical and feasibility work has been completed and appropriate procurement and delivery arrangements evaluated. This project will become a consideration for the resourcing of the Learning Estate Review Delivery Plan.

## **7 BACKGROUND PAPERS**

### 7.1 December Council Report

#### Appendix 1 – Consultation Analysis

<b>AUTHOR'S NAME</b>	Douglas Proudfoot
<b>DESIGNATION</b>	Executive Director for Place
<b>CONTACT INFO</b>	<a href="mailto:dproudfoot@eastlothian.gov.uk">dproudfoot@eastlothian.gov.uk</a>
<b>DATE</b>	1 June 2022



**Project Title:** ELC Learning Estate Review  
**Report:** Summary Report on the consultation responses for the re-provision of East Linton Primary School  
**Issue Date:** 19/5/22  
**Prepared by:** Kenny Campbell (HUB)  
Jo Allen & Graeme Marsden (ELC)



## **Introduction**

---

1. Hub South East were asked to review the consultation responses for the re-provision of East Linton Primary School and provide a summary report. This summary report was then updated by ELC staff to include additional qualitative analysis of consultation responses received.

## **Overview**

---

2. The consultation followed a decision by East Lothian Council in December 2021 to instruct officers to explore options for a replacement East Linton Primary School adjacent to the current school building. A key element of the consultation was the assessment of three potential layouts for the location of the replacement school:
  - Layout A shown on Appendix 1 would be built on land west of the existing school for the most part allocated for education use in the 2018 Adopted East Lothian LDP and held under the education account.
  - Layout B shown on Appendix 2 would site the school in a south-central location of the Memorial Park.
  - Layout C shown on Appendix 3 would be built in the south of Memorial Park, approximately where the tennis courts are located to the south of the existing school.
3. The consultation period ran from the 1<sup>st</sup> to 28<sup>th</sup> February 2022. A specific webpage was set up on the Council website with information on the project, including the 2021 December Council Report and accompanying layouts. A consultation questionnaire was set up under the Council's consultation portal and this is where the majority of responses were submitted, although the Council would also accept responses by email or letter. The consultation and the website was promoted heavily through social media and through Council contacts with local organisations and groups. Officers attended meetings of East Linton Primary Parent Council and Dunsper Community Council and a public drop in event with two Council officers present was held on Saturday 12 February where anyone could come and ask questions about the replacement school proposal and the layouts –

Feedback from this event is set out in Appendix A. Posters were placed in local shops, a large banner was placed on the primary school railings and there was an article in the East Lothian Courier during the middle and towards the end of the consultation period.

4. As well as asking for essential responder data, there were 17 main consultation questions on the portal and they were grouped under headings of School, Site, Greenspace and Community Facilities. Their purpose was to generate and seek opinion from responders on:

- priorities to help the Council create a new primary school that is fit for modern learning;
- views on potential layouts that have been designed;
- perspectives on the open green space and built facilities at Memorial Park; and
- options for community facilities and wider benefits.

**Table 1 – Consultation Portal Questions**

<b>School</b>	What are your aspirations for the new school building to ensure it facilitates excellent learning experiences for children at East Linton Primary?
	How can we maximise the opportunities that come from having a new school in the heart of the East Linton community? What suggestions do you have?
	How could the grounds of the new East Linton Primary School facilitate healthy living and outdoor learning during and outwith the school day?
	In what ways could the new school building be more environmentally-friendly and sustainable?
<b>Site</b>	What are your views on the three proposed layouts? Do you have a preference?
	Have we outlined the key considerations for each of these proposals? What do you feel we should also include?
	How can we maximise the energy efficiency of the building and its positive impacts?
	How could we minimise the impacts on the neighbouring green spaces, parking and local residents?
<b>Green Space</b>	How do you currently use War Memorial Park? What do you particularly value from the space?
	Which layout do you feel is best for green space and park use?

	Would any of the layouts impact on any events held in the park or other activities that you enjoy? Is there one option that is more suitable than the others?
	Do you have any suggestions on how we can balance the provision of a new school at this site with the need to maintain green open space?
	What are your views on the potential locations for replacement facilities shown in the proposed layouts?
<b>Community Facilities</b>	How and where do you think we should locate new changing and toilet facilities as part of a re-provided pavilion?
	How could space within a replacement school building support community activities? What type of activities and facilities would offer benefits to East Linton?
	How could the school's outdoor space benefit the community outwith school hours?
	What other issues should we bear in mind regarding the provision of community facilities?

5. There was also a response box where responders could share any additional points they wished to make. The consultation questions were developed to be open and to elicit a range of feedback from all members of the community. Respondents could provide as much or as little detail as they felt appropriate and were able to focus on only one section if they preferred.
6. Some respondents commented that they did not agree with the format of the questions and felt there was undue repetition. Others were in favour of the consultation and welcomed the proposed investment in upgraded facilities and the opportunity to share their views.

### **Quantum of Responses**

7. Not including school class/year responses (see later in report), 83 responses were received in total, with 72 through the consultation portal, ten via email and one letter. Four of the responses represented organisations with the remaining 79 from individuals, couples or families.
8. As part of the consultation portal questionnaire, responders were asked if they had a child at East Linton Primary. For those, who answered the question, 29 said yes and 34 said no. It should be noted that regardless of the answer to that question, the vast majority of

responses saw benefits of delivering a replacement or refurbished school over the existing facility.

### **Organisation Responses**

9. Four responses were received from organisations. These were:
  - Dunpender Community Council
  - East Linton Primary School Parent Council
  - East Linton After School Club
  - Climate Action East Linton
  
10. Dunpender Community Council are overall supportive of the re-provision of the new school with modern, flexible use facilities and a bigger playground and their preference is for layout A of the three available but with caveats, including that the Council should acquire land adjoining the town for sports and recreation. They support community use of facilities due to village hall pressures and use by before and after school clubs. Sustainable design options are supported, including incorporating renewables and orientating for solar gain but allowing for windows that open. They note that all elements of park are well used and the facilities within it should be replaced and there should not be a time during re-provision where facilities are not provided. They would have liked for a non-park layout but understood reasons why this was not possible.
  
11. The Parent Council are supportive of the replacement school option with layout A preferred. They suggest a number of facilities that they would like to see incorporated into the new design including all weather pitch, library, open spaces between classes to allow shared learning, large enough playground and use of facilities outside of core school hours. They are strongly supportive of making the building as sustainable as possible not just in design but in its operation too. As with the community council they also support securing new green space elsewhere in East Linton. They recognise that the school, the site, the surrounding green space and associated community facilities are all equally important and that a replacement school is ideal opportunity to improve the quality and potential of all of these facilities.
  
12. The After School Club are supportive of a replacement school and cite the recent Wallyford and Letham Mains models of service delivery in partnership with the school, local communities and organisations serving the families. They did not state a preferred layout but wish to see sustainable design and support a layout in a way to encourage outdoor quality play and recreation and with a model that physically discourages vehicles

in or around the school and encourages bikes and pedestrian areas leading to and from the school area.

13. Climate Action East Linton would wish to see a replacement school create an environment which is inspiring for children and teachers. They do not prefer any individual layout over the other as they believe them to be simplistic and require further work but they do state that the siting the school in the north west of park (layout A) reduces the division of green space. They provide considerable comments on sustainable construction, design and use of the building including maximising the use of natural materials, including wood and green roofs. They acknowledge the need for a two storey building but that this should be as low as possible. As with others, they note that the new facilities should not detract from existing facilities such as the Village Hall and Library and that the old school building could be used as a community resource and centre. They also provide comments on the park and its use and importance including for wildlife.
14. Minutes of a meeting of East Linton Tennis Club were provided to the Council and whilst not a formal response it is worth highlighting some key points. They do not have a preferred option but they would have preferred the option of a 4<sup>th</sup> option outside of the park. They are most concerned about the unavailability of the tennis courts during any construction process, where they could use alternative courts if lost for a period during construction and the subsequent impact on members. They would prefer that the tennis club could also have access to the new pavilion as a shared facility. They have further questions on surfacing and whether the replacement courts would be lit.

### **Public Responses**

15. This section sets out a summary of responses by the four question headings for those individuals who submitted responses.

### **School**

16. The majority of respondents were in favour of the creation of a new school for East Linton. The open nature of the questions allowed respondents to share both general comments in terms of their aspirations for the school such as safe, modern, light-filled, to more detailed observations relating to facilities and resources that they felt would benefit the school and wider community. The majority of respondents emphasised the importance of space – both in terms of the space within the school building and its grounds, and maximising the amount of space that would remain for the community in the wider park. It is clear that the school's position in relation to the parkland and preserving open green space is an important consideration to all respondents even those in support of the school's re-provision on the existing education land.

17. Many respondents felt that the school could provide further benefit to the community by opening up the facilities to the community outwith school hours, including pitches, meeting rooms or other spaces such as an assembly hall for drama productions, or by providing other facilities such as a library from the school building.
18. Outside space was frequently mentioned by respondents both in terms of allowing access outwith school hours and also to provide adequate and inspiring space for play and outdoor learning. This was reflected in feedback that suggested the school's grounds could be used as an opportunity for partnership including intergenerational learning projects with members of the community or with the Council's Outdoor Education or Active Schools services.
19. Sustainability was a key theme amongst the feedback. Respondents frequently cited a desire for a building that supported energy efficiency and climate change ambitions and promoted best practice. Passivhaus was seen as advantageous alongside other measures including best use of natural light, effective insulation, solar panels, wind turbines, ground or air source heating, and a 'living' green roof.
20. While the consultation was not specific to the design of the building as this will be considered and consulted upon at a later point, some respondents did express opinions on their aspirations for a building. They outlined a desire for high quality, modern building but also in keeping with the surrounding and the location within the heart of the village's conservation area. A number of respondents pointed to the longevity of the existing Victorian building and hoped that any new school would also last, while others hoped that the existing frontage could be retained as a link to the school's history. Respondents hoped that the school would be future proofed both in terms of the ability to accommodate future expansion of school roll and in terms of energy efficiency practice. The school's location in a residential area was mentioned to highlight the need to reduce the impacts on neighbouring properties, discourage car use and promote active travel.
21. Not all respondents were supportive of the proposal to provide a new school at the proposed locations in the layouts. The three reasons that were put forward related to the loss of amenity space and parkland, a desire to see the existing building refurbished and repurposed, or comments that investment should be made in teachers, not buildings.

## **Site**

22. There were four questions in relation to the school's proposed layout within the wider space/location. Respondents used this section to discuss the potential layouts and the

respective merits (or not) of each. Some participants provided detailed feedback on their reasons for support or otherwise of the location. The three potential layouts are shown in at the end of this report.

23. Of those respondents who expressed a preference for one of the three layouts, option A, which sees the majority of the development concentrated on land held on the education account, was the most popular. The breakdown of responses to this question was as follows:

- Layout A                      37
- Layout B                      1
- Layout C                      7
- No Preference                9
- Opposed all options        18

24. Layout A received further support in four of the email responses, with one email preferring Layout C

25. Respondents in support of layout A did so for a number of reasons, principally the possibilities for energy efficiency and sustainability and the consolidation of the build in the north west corner keeping the school separate from the wider public park and its amenities including the Memorial Park, skate park, tennis club and football pitch.

26. For those who were opposed to development on the education land (Myra's Field) or Memorial Park in any of the layouts, the main reasons that were proposed correlate with the feedback from section 1 (school): loss of green space, development on valuable open space and the visual impact of any development.

27. Some respondents commented that they preferred layout A but would rather see this at a different location rather than at the current site. This is taken to mean that respondents favoured the aspirations for energy efficiency proposed through layout A but did not agree with the location at the current site.

28. A number of respondents also suggested that the current building and frontage could be reused and the school located on its current site.

29. The feedback on 'impacts' was in line with the answers provided in section 1 (school). Parking and car access were repeatedly raised as requiring consideration on a narrow residential street. The loss of the village's only green open space for informal use such as

dog walking as well as for formal events such as the Gala was a concern. A small number of respondents felt that it would not be possible to minimise the impact of development on these events and the park in general. Respondents also valued the trees and open aspects of the space.

30. Respondents also were keen for more detail on design features and for the community's views to be considered. This included for elements such as screening and fencing, and the location and flow of paths around the spaces. The requirement for safe paths for cycling, walking and active travel were mentioned along with a need to consider landscaping and planting during the design process.
31. Energy efficiency measures including solar panels, maximising solar gain, sound and heat insulation were proposed as ways to maximise the efficiency of the building. However respondents pointed to the need for expert advice and guidance in this area to ensure a building that was truly efficient and sustainable.

### **Green Space**

32. It is clear from all areas of the consultation feedback that the green space is much valued by the community and well used for a range of formal and informal activities. All of the respondents outlined ways that they currently use Memorial Park and the green space. Many respondents mentioned they valued the trees, the wildflower areas, and the opportunity to connect with nature in the heart of the village. Key elements of value that should be taken into account are: space for formal and informal recreation and play, the ability to hold larger all-village events, space for quiet reflection, enabling connection with nature and enhancing the natural environment, dog walking and exercise for all ages and members of the community. Most respondents, even those who were very supportive of a new school, were keen to minimise impacts as much as possible on the green space.
33. As previously mentioned, a number of respondents were opposed to the school's development at the site and felt that it would not be possible to balance these two elements; relocation to an alternative site or redevelopment on the current location were preferred by these respondents. Others have pointed to ways that they think could help mitigate any loss alongside development at School Road. This includes co-location of some of the built facilities (e.g. changing pavilion) within the school, using the location to the north west space which is allocated for education use (layout A), allowing out of hours access to school facilities such as pitches, and minimising car access and parking on a narrow residential space.



34. A number of respondents specifically highlighted the potential impacts on space to hold the gala. Other events including a highland dance competition were highlighted. Layout A was again highlighted as a way to consolidate the park space to keep as much open aspect as possible. Layouts B and C were suggested as having least impact on some of the particular groups within the community (e.g. those who use the football pitches) however it was recognised that this was only during the sporting season.

### **Community Facilities**

35. There were a range of comments in this section focusing on the facilities that currently exist, the potential layout for the inclusion of these alongside a reprovided school, and what further benefits the community could derive from any works. A small number of respondents again highlighted impacts on traffic and cars, parking in particular in relation to managing the interaction with the station once opened.
36. The majority of respondents agreed that the current facilities – public toilets and changing pavilion – were valued and should continue to be provided. Opinions were split between those who thought they should remain in their current locations and those who felt it should be provided as part of any new development. Several respondents also proposed that facilities could be provided as part of a redevelopment of the existing school building including co-working spaces. The space to the rear of the school which currently holds the school extension was mentioned as an area that could also be developed if this minimised the impacts on the open green space.
37. The visual impacts of a new school development was also repeatedly mentioned. Alongside a desire to maintain as many trees as possible, which has been noted elsewhere in this analysis, landscaping was also mentioned. Respondents commented on the need to ensure that fencing did not have a negative impact on the open look and feel of the spaces, creating built zones and that careful attention should be taken to manage the flow of the park.
38. Further, respondents felt that allowing access to the school outwith school hours could be a way to increase benefits from the development. It was suggested that access to the building, gardens and pitches could support a range of activities including sports and exercise clubs, after school and wraparound care, community classes and space for community groups to meet without the need to travel to Dunbar. Access to the school's gardens was repeatedly mentioned including potential for picnic table provision.

39. Some respondents commented that they felt there was sufficient facilities already within the village, and also that any development of new facilities, e.g. for meetings, should not be at the expense of the viability of existing facilities such as the village hall.
40. Climate change and sustainability continued as a theme including preserving trees and creating nature spaces within the school grounds.
41. Some respondents continued to oppose the redevelopment of the school at the current site and advised that they would prefer an alternative site was identified away from the park.

#### **Other**

42. Space was included to allow respondents to share any additional views that they had not been able to identify elsewhere.
43. In general terms respondents used this space to express the key areas of support or opposition to the scheme with strong views on each side. The value of the park was highlighted by all those who responded. The importance of further ongoing consultation was highlighted alongside the need for further detailed plans. These are both areas that will be central to plans going forward.
44. Parking and access came up in many responses as a specific issues and therefore it is worth collating those matters. For many the central location of the school and the new school is critical in maximising walking and cycle access to school and to discourage those driving or drop offs. However, many who live in the vicinity of School Road, Bank Road or Walker Terrace write that drop offs and parking on those streets is a significant concern and this must be addressed in the design of the new school. Photos of unacceptable parking were provided.

#### **School Responses**

---

45. All school year groups and the nursery class were asked about their thoughts on the re-provision options. Each year group was asked to provide comments under four headings:
  - The School
  - The Site
  - Green Space
  - Community Facilities

46. For the purpose of this summary, two tables are set out below grouping the key messages from the responses for firstly nursery to P3 and then P4 to P7 under the four headings.

**Table 2 - Nursery to P3**

<b>School</b>
Better, bigger playground with play equipment. Dedicated dining and sports halls Better sports facilities Environmentally friendly, sustainable construction, More and larger windows that let in more light Larger classrooms More toilets Improved ICT Facilities
<b>Site</b>
Preference for minimal or no parking and that people should walk or cycle to school Minimise greenspace loss Mixed messages on layout preferences with some preferring B or C but stating that A preserves the largest amount of green space
<b>Green Space</b>
Clearly appreciate the memorial park and overall green space and use it extensively Importance of trees and flowers. War memorial respected
<b>Community Facilities</b>
Weekend use of indoor and outdoor facilities including school playground Use of facilities by groups (e.g. Rainbows) and sports clubs

**Table 3 - P4 to P7**

<b>School</b>
Larger, brighter classrooms Breakout areas and quiet spaces Separate PE and dining Sustainable construction, energy efficient with renewable technologies Better heating, toilets and ICT facilities Improved, larger playground with facilities including outdoor learning areas Improved school security Bigger library Better sports facilities including multi use 3G pitch swimming pool and basketball court

<b>Site</b>
Mixture of responses with some A, B and C. Most state that A has most green space. Strong preference for layout A from P7 Building that fits with surroundings
<b>Green Space</b>
Appreciate the Memorial Park and overall green space and use it extensively War memorial respected, park open space is important as used for multiple purposes including to play football, use the skateboard park, play with our friends, Don't want all of the green space to be developed Consideration given to the well-established trees, plants and wildlife during the build. Consideration given to the traffic and parking as this is already a busy part of the village. More green space than currently More trees and recognise importance of community garden
<b>Community Facilities</b>
Multi use spaces within the school that can be used all year round The availability of outdoor spaces may encourage more sport and fitness clubs to be set up for the community to access. Community Library in the school Benches in the park Provision of bike racks

47. From above it is clear there are a number of recurring themes:

- Clear desire for a modern larger, better school building with modern facilities;
- Sustainable construction and design is important;
- All classes requested more and bigger gym, outdoor and sports spaces that covered all typical facilities, although some other requests may be ambitious such as 'swimming pool', 'climbing wall' and 'trampoline room';
- Mixed messages over preferred layout but it was recognised in a number of class responses that A offered the best layout from an open and green space perspective;
- The children clearly appreciate the Memorial Park and overall green space and use it extensively. All classes noted how they used the space including the use of the skate park, playing football, building dens and playing in the playpark;
- Encourage the inclusion of multi-use spaces within the school that could be used by the community. The children listed many extra-curricular clubs that they would like to see such as gymnastics, dance, rugby, Enjoyaball, art classes etc.; and
- Access to facilities outwith school hours to use facilities such as the football pitch or basketball court.

## **Appendix 1**

---

### **Drop in Event Feedback**

The following is a summary of officer notes from comments and questions received at the drop in event at the Mart in East Linton on Saturday 12 February from 9am till 2pm. The event was for people to turn up and ask any queries or questions and for officers to promote the consultation. Feedback has been grouped below under the four headings of the consultation questionnaire.

#### **Site**

- For those who wanted to express an opinion on the 3 layout options, A was the most popular.
- Significant number felt that options outside the park should be considered even after explaining ownership and village constraints issue. This was due to loss of park space. The Council should just buy a site through compulsory purchase.
- Another option that attendees felt should not be ruled out is replacing school on existing site to minimise park impact, with Victorian part incorporated into new school. Explained that this would result in costly decanting of temporary units on park but many were willing to accept short term pain to avoid long term park loss. One suggested demolishing the whole school and replacing on that site to minimise impact on park.

#### **School**

- After school clubs need to be accommodated within the new school and not a separate location.
- Use of facilities should be more than just the sports hall outside school ours but also pitches and potential meeting and performance spaces within the school.
- Various views on parking for school. Those who lived on streets nearby who were affected by drop off and staff parking were supportive of providing more dedicated parking. Those with less of an interest were keen to see parking minimised as it would impact on park.
- Need to consider building orientation to avoid park being overshadowed.
- Need to consider orientation of classroom to avoid trains going past being a distraction for pupils.

#### **Green Space**

- Mixed views on retention of the community woodland. Mostly support but others would be willing to lose if school could be developed on existing site rather than expanding significantly into park.

- Impact on avenue of mature trees on School Road should be minimised/not impacted at all as it takes time to re-establish trees.
- Need to ensure landscape architect is employed early in design process.

### **Community Facilities**

- Strong support for use of sports hall and 2g pitch for community use outside school hours.
- Skate park and play park should be separate and not co located due to differing age groups
- Tennis courts could be made free, should be on a north-south alignment and should not have a tarmac surface as current.
- Remaining Victorian school building could be used for small office units. Some suggested parts of the school (offices?) could be located in there to reduce size of new building and make use of existing facility.
- Many comments focussed on what the existing Victorian part of the school would be used for.

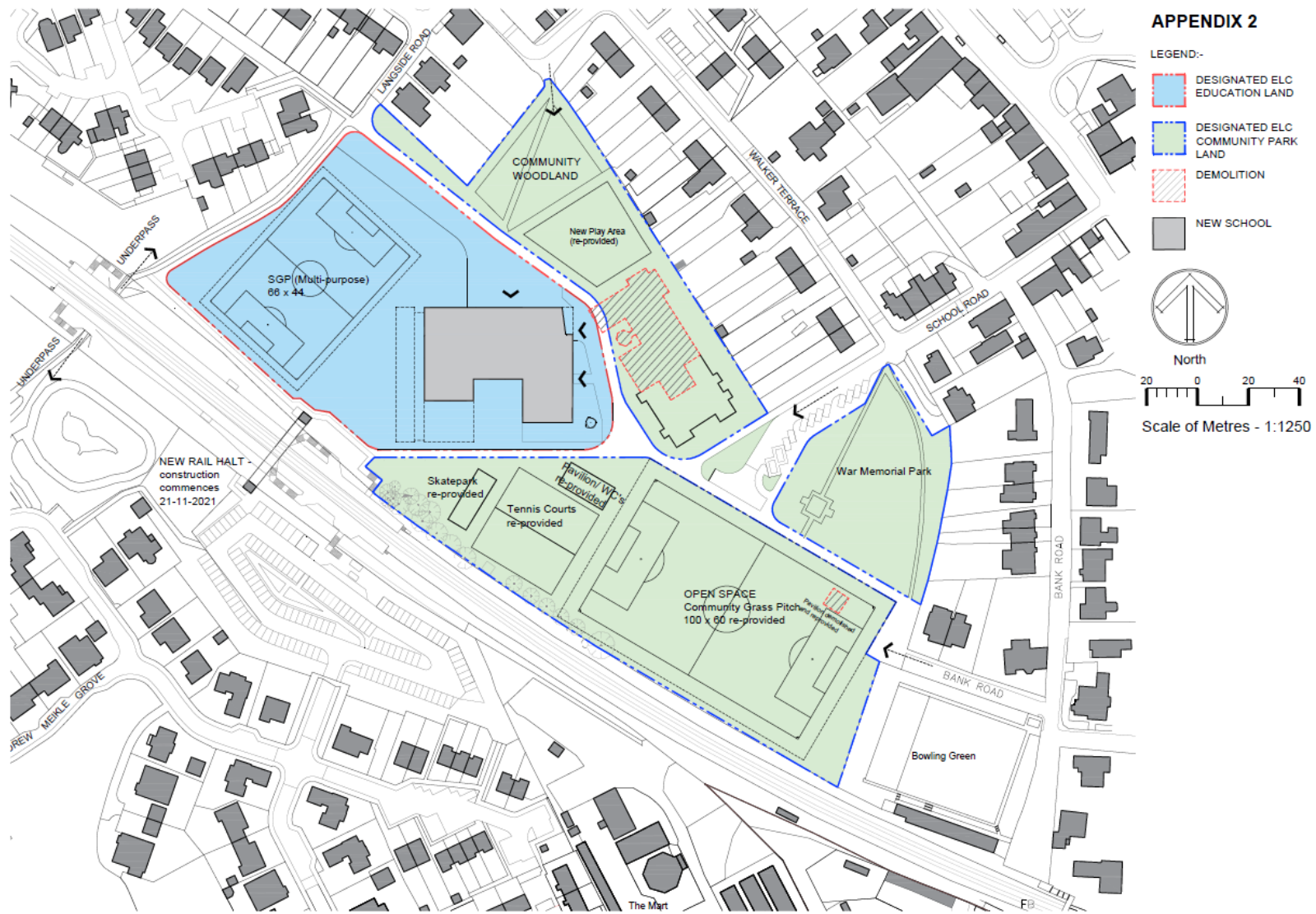





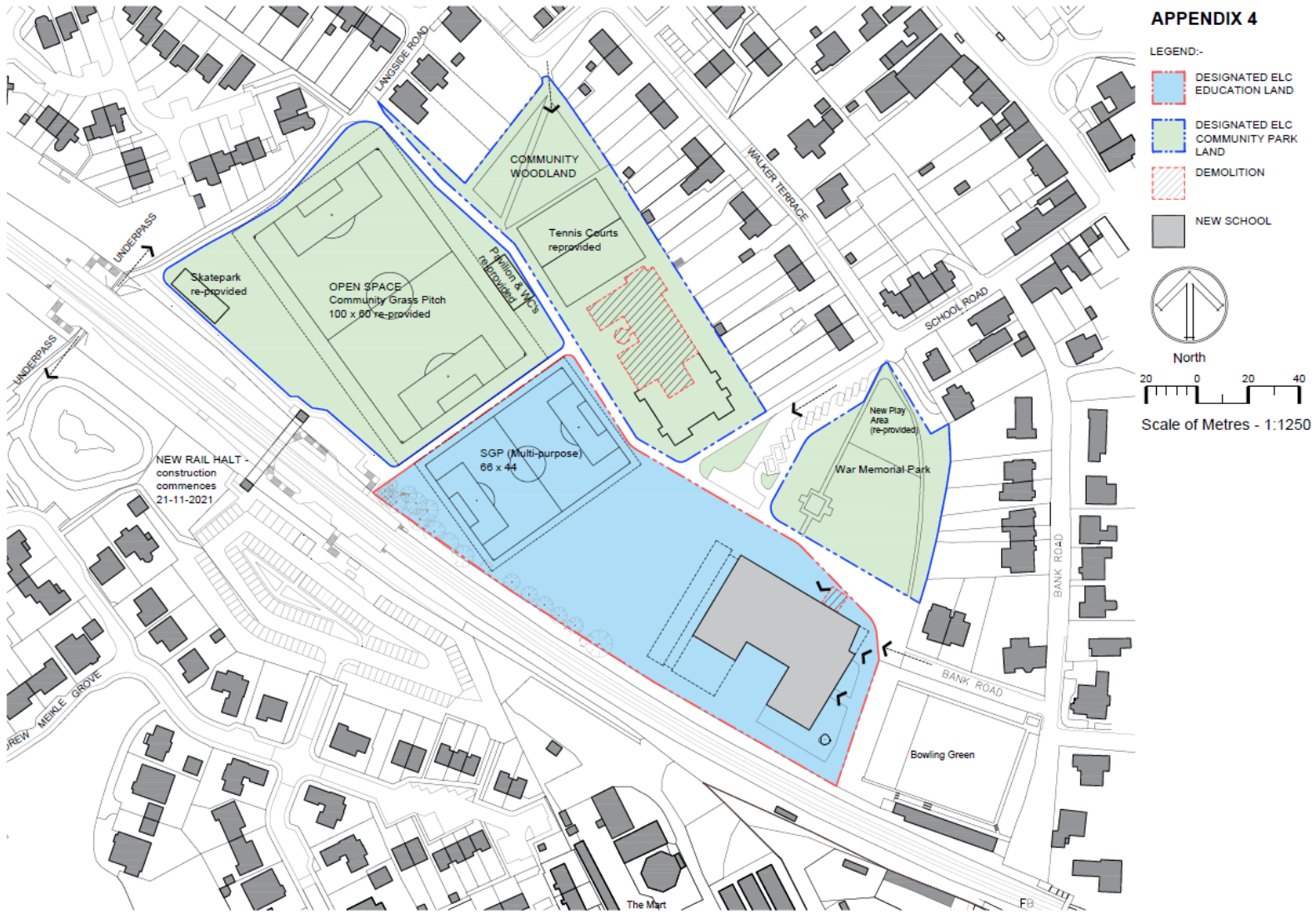

Layout C