



APPLICATION FOR PREMISES LICENCE / PROVISIONAL PREMISES LICENCE*

LICENSING (SCOTLAND) ACT 2005, SECTION 20

2d

*Delete as appropriate

Question 1 - Name, address and postcode of premises to be licensed

The Cheese Lady
3 Court Street
Haddington EH41 3JD

Question 2 - Particulars of applicant

2(a) Where applicant is an individual, provide full name, date & place of birth, home address including postcode, telephone number & email address.

2(b) Where applicant is a partnership, please provide full name, and postal address of partnership.

The Cheese Lady
3 Court St, Haddington EH41 3JD

2(c) Where applicant is a company, please provide name, registered office and company registration number.

2(d) Where the applicant is a club or other body, please provide full name, and postal address of club or other body.

2(e) Where applicant is a partnership, company, club or other body, please provide the names, dates and places of birth, and home addresses of connected persons.*

1. *Svetlana Kukharuk*, [REDACTED]

2. *Pauline Isabella Lunan*; [REDACTED]

[REDACTED]

* Connected person is defined in section 147(3) of the Licensing (Scotland) Act 2005.

Question 3 – Previous applications

Has the applicant been refused a premises licence under section 23 of the Licensing (Scotland) Act 2005 in respect of the same premises?

YES NO

If YES – provide full details _____

Question 4 – Previous convictions

Has the applicant or any connected person ever been convicted of a relevant or foreign offence (1)

YES NO

If YES – provide full details. For the purpose of this Act, a conviction for a relevant offence or foreign offence is to be disregarded if it is spent for the purpose of the Rehabilitation of Offenders Act 1974.

| NAME | DATE | COURT | OFFENCE | SENTENCE |
|------|------|-------|---------|----------|
| | | | | |
| | | | | |
| | | | | |
| | | | | |

(1) In addition to any convictions held by the applicant at the time of application, applicants should also familiarise themselves with the contents of section 24(1) of the Licensing (Scotland) Act 2005 in respect of any convictions for relevant or foreign offences which they may receive during the period beginning with the making of the premises licence application and ending with determination of the application.

DESCRIPTION OF PREMISES

Licensing (Scotland) Act 2005, section 20(2)(a)

Question 5 – Description of premises

(where application is submitted by a members' club, please also complete question 6)

A ground floor shop with 3 rooms (front shop, cheese maturation room, & back prep room) & WC

Question 6 – To be completed by members' clubs only

Do the club's constitution and rules conform to the requirements of regulation 2 of the Licensing (Clubs) (Scotland) Regulations 2007?

YES NO

DECLARATION BY APPLICANT OR AGENT ON BEHALF OF APPLICANT

The contents of this Application are true to the best of my knowledge and belief.

Signature _____ * (see note below)

Date 01.08.2021

APPLICANT / AGENT (delete as appropriate)

Telephone number and email address of signatory _____

Svetlana@thecheerslady.co.uk

I have enclosed the relevant documents with this application – please tick the relevant boxes

- Operating plan
- Layout plan (highlighting the area where alcohol is sold/consumed)
- Planning certificate
- Building standards certificate
- Food hygiene certificate

*** Data Protection Act 2018**

The information on this form may be held on an electronic public register which may be available to members of the public on request.

| For use by the Licensing Board only Application checklist | |
|--|--|
| Date received | |
| Fee amount | |
| Receipt number | |
| Received by (INITIALS) | |
| Consideration date | |
| Last date for consideration | |
| Date of initial hearing | |
| Date of any modification hearing | |
| Date granted/refused (delete as appropriate) | |

| For use by the Licensing Board only If application is for a Premises Licence – Documents required | |
|--|--|
| Operating plan | |
| Layout plan | |
| Planning certificate | |
| Building standards certificate | |
| Food hygiene certificate | |

| For use by the Licensing Board only If application is for a Provisional Premises Licence Documents required | |
|--|--|
| Provisional planning certificate | |
| Operating plan | |
| Layout plan | |



OPERATING PLAN

LICENSING (SCOTLAND) ACT 2005, SECTION 20(2)(B)(i)

This application should only be completed by the Licence Holder of the appropriate Premises Licence or their Agent.

1. STATEMENT REGARDING ALCOHOL BEING SOLD ON PREMISES/OFF PREMISES OR BOTH

Name and Address of Premises _____

The Cheese Lady

3 Court Street

Haddington

Post Code

EH41 3JD

1(a) Will alcohol be sold for consumption solely ON the premises?

YES NO

1(b) Will alcohol be sold for consumption solely OFF the premises?

YES NO

1(c) Will alcohol be sold for consumption both ON and OFF the premises?

YES NO

2. STATEMENT OF CORE TIMES WHEN ALCOHOL WILL BE SOLD FOR CONSUMPTION ON PREMISES

| DAY | ON CONSUMPTION | |
|-----------|----------------|---------------|
| | Opening time | Terminal Hour |
| Monday | 10 am | 10 pm |
| Tuesday | 10 am | 10 pm |
| Wednesday | 10 am | 10 pm |
| Thursday | 10 am | 10 pm |
| Friday | 10 am | 10 pm |
| Saturday | 10 am | 10 pm |
| Sunday | 10 am | 10 pm |

3. STATEMENT OF CORE TIMES WHEN ALCOHOL WILL BE SOLD FOR CONSUMPTION OFF PREMISES

| DAY | OFF CONSUMPTION | |
|-----------|-----------------|---------------|
| | Opening time | Terminal Hour |
| Monday | 10 am | 10 pm |
| Tuesday | 10 am | 10 pm |
| Wednesday | 10 am | 10 pm |
| Thursday | 10 am | 10 pm |
| Friday | 10 am | 10 pm |
| Saturday | 10 am | 10 pm |
| Sunday | 10 am | 10 pm |

4. SEASONAL VARIATIONS

Does the applicant intend to operate according to seasonal demand?

YES NO

*If YES – provide details

5. PLEASE INDICATE THE OTHER ACTIVITIES OR SERVICES THAT WILL BE PROVIDED ON THE PREMISES IN ADDITION TO SUPPLY OF ALCOHOL

| ACTIVITY | ACTIVITY PROVIDED? YES / NO | To be provided during core licenced hours. Please confirm YES / NO | Where activities are also to be provided outwith core licensed hours. Please confirm YES/NO |
|----------|--------------------------------|--|---|
|----------|--------------------------------|--|---|

| | | | | |
|-----|-----------------------|--------------------|------------|-----|
| 5a. | Accommodation | <i>No</i> | N/A | N/A |
| | Conference facilities | <i>No</i> | | |
| | Restaurant facilities | <i>No</i> | | |
| | Bar meals | <i>Cheers only</i> | <i>Yes</i> | |

Social functions including:

| | | | | |
|-----|---|-----------------------|------------|--|
| 5b. | Weddings, funerals, birthdays, retirements etc. | <i>No</i> | | |
| | Club or other group meetings etc. | <i>Tasting events</i> | <i>Yes</i> | |

Entertainment, including:

| | | | | |
|-----|----------------------------|-----------|--|--|
| 5c. | Recorded music – see 5(g) | <i>No</i> | | |
| | Live performances see 5(g) | <i>No</i> | | |
| | Dance facilities | <i>No</i> | | |
| | Theatre | <i>No</i> | | |
| | Films | <i>No</i> | | |
| | Gaming | <i>No</i> | | |
| | Indoor/outdoor sports | <i>No</i> | | |
| | Televised sport | <i>No</i> | | |

| | | | | |
|-----|-----------------------------|-----------|--|--|
| 5d. | Outdoor drinking facilities | <i>No</i> | | |
|-----|-----------------------------|-----------|--|--|

| | | | | |
|-----|---------------------|-----------|--|--|
| 5e. | Adult Entertainment | <i>No</i> | | |
|-----|---------------------|-----------|--|--|

Where you have answered YES in respect of any entry in column 4 above, please provide further details below.

| |
|--|
| |
|--|

5(f) If you propose to provide any activities other than those listed in 5(a) - (e), please provide details or further information below.

5(g) Late night premises opening after 1.00am

Where you have confirmed that you are providing live or recorded music, will the decibel level exceed 85dB?

YES NO

When fully occupied, are there likely to be more customers standing than seated?

YES NO

6. ON-SALES ONLY – CHILDREN AND YOUNG PERSONS

6(a) When alcohol is being sold for consumption on the premises will children or young persons be allowed entry?

YES NO

6(b) Where the answer to **6(a)** is YES provide statement of the TERMS under which they will be allowed entry

Children will only be allowed accompanied by a responsible adult(s); They will be allowed into the shop for shopping but not for sitting at the micro cafe. Children will not be allowed to attend tastings.

6(c) Provide statement regarding the AGES of children or young persons to be allowed entry

Any age, but for shopping only

6(d) Provide statement regarding the TIMES during which children and young persons will be allowed entry

During opening times

6(e) Provide statement regarding the PARTS of the premises to which children and young persons will be allowed entry

The front shop only (the shopping area)

7. CAPACITY OF PREMISES

What is the proposed capacity of the premises to which this application relates?

Shopping area 4-6
Sitting area 4-6

8. PREMISES MANAGER

(NOTE: not required where application is for grant of provisional premises licence)

Full Name *Svetlana Kukharчук*

Date of birth [REDACTED]

Contact address [REDACTED]

Post Code [REDACTED]

Tel. No. [REDACTED] Email address *svetlana@thecheerbody.co.uk*

Personal licence

Date of issue *12.11.2010*

Name of Licensing Board issuing *Life Licensing Board*

Reference no. of personal licence *FI 2554*

DECLARATION BY APPLICANT OR AGENT ON BEHALF OF APPLICANT

If signing on behalf of the applicant please state in what capacity.

The contents of this operating plan are true to the best of my knowledge and belief

Signature  (* see note below)

Date 31.05.2021

Capacity APPLICANT / AGENT (delete as appropriate)

Tel. No. of signatory 

Email address svetlana@thecheerlady.co.uk

*** Data Protection Act 2018**

The information on this form may be held on an electronic public register which may be available to members of the public on request.

Site Plan/Block Plan of 3 Court Street, Haddington EH41 3JD

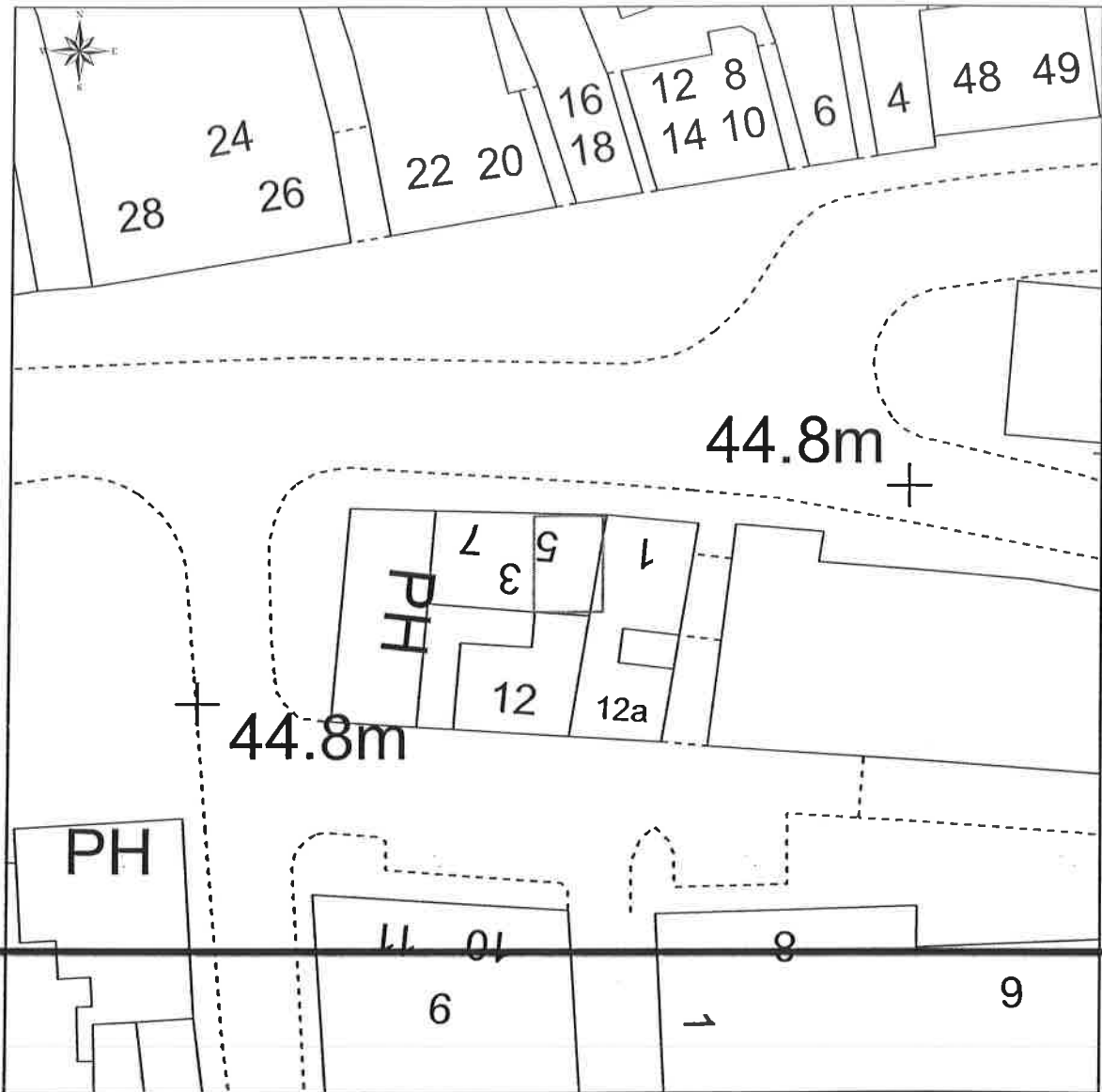

This Plan includes the following Licensed Data: OS MasterMap, Black and White Site Plan/Block Plan by the Ordnance Survey National Geographic Database and incorporating surveyed revision available at the date of production. Reproduction in whole or in part is prohibited without the prior permission of Ordnance Survey. The representation of a road, track or path is no evidence of a right of way. The representation of features, as lines is no evidence of a property boundary. © Crown copyright and database rights, 2021. Ordnance Survey 0100031673





0m 5m 10m 15m 20m 25m 30m 35m 40m

Scale: 1:500, paper size: A4

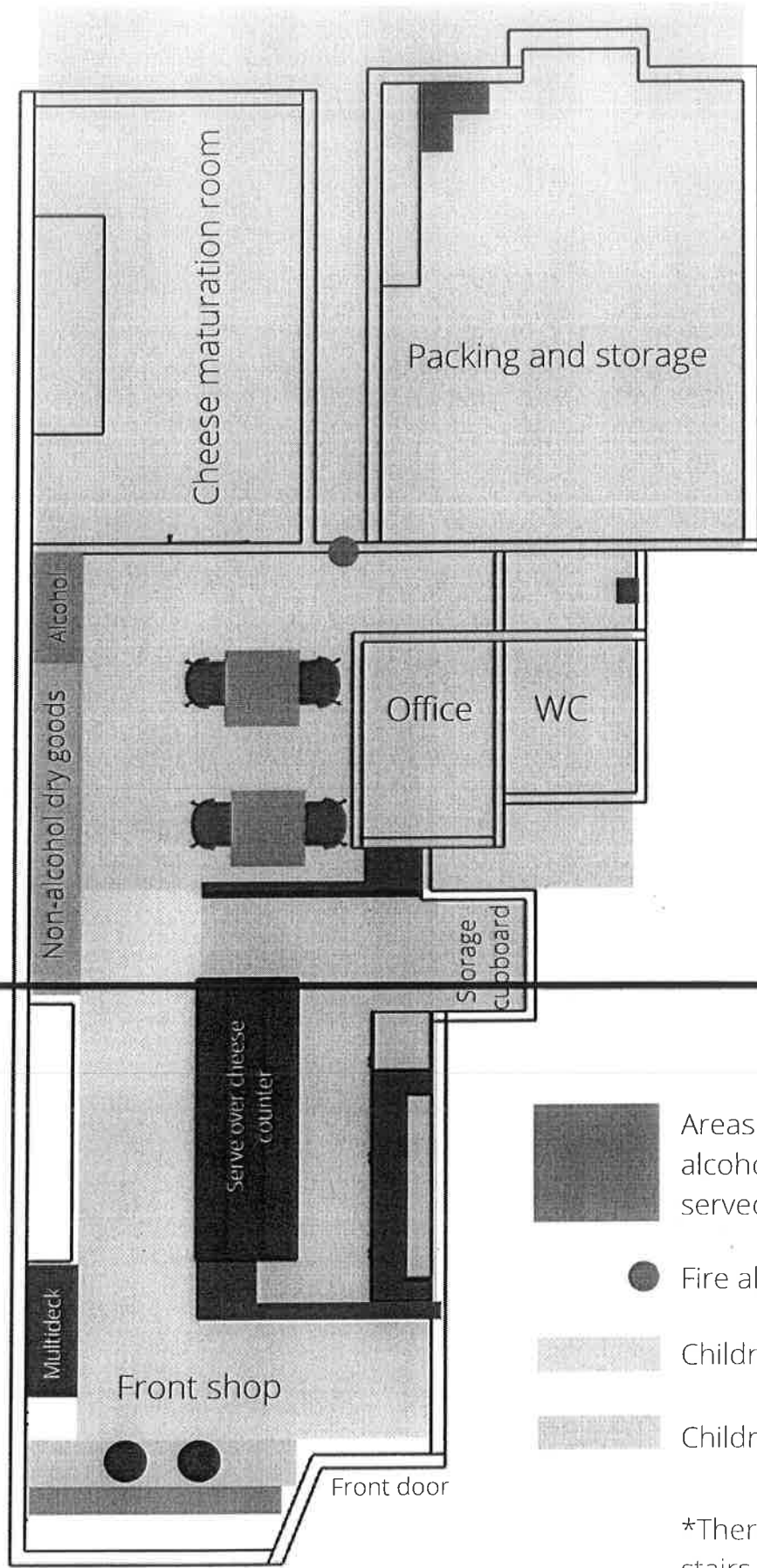

emapsite™
plans



-  Areas in pick are where alcohol will be sold and served
-  Fire alarm
-  Children allowed
-  Children not allowed

*There are not steps, stairs, lifts or elevators

LAYOUT PLAN

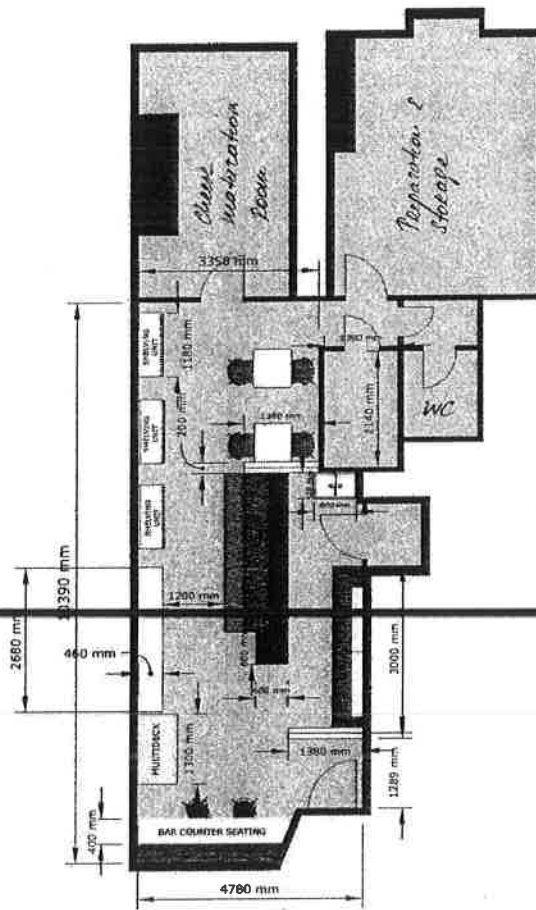

**SECTION 50
PLANNING CERTIFICATE**

Fax 01620 827253
 Email:licensing@eastlothian.gov.uk

| | |
|--------------------------------------|---|
| APPLICANT: | Mrs Svetlana Kukharchuk |
| NAME AND ADDRESS OF PREMISES: | The Cheese Lady, 3 Court Street, Haddington, EH41 3JD |

SECTION 50 PLANNING CERTIFICATE

I confirm that planning permission (ref:.....) under the Town and Country Planning (Scotland) Act 1997 in respect of any development of the subject premises in connection with their proposed use as a licensed premises has been obtained.

I confirm that planning permission is not required.

SECTION 50 PROVISIONAL PLANNING CERTIFICATE

I confirm that planning permission (ref:.....) or outline planning permission (ref:.....) has been obtained in respect of the construction or conversion of the subject premises.

I confirm that planning permission is not required.

I hereby confirm that, in terms the above Acts, I have no objections to the granting of the Confirmation of the Premises License to cover the above proposals.

| | | | |
|----------------|---|--------------|---------------------------|
| Signed: |  | Date: | 7 th June 2021 |
|----------------|---|--------------|---------------------------|

Keith Dingwall
 Service Manager, Planning

From: The Cheese Lady <svetlana@thecheeselady.co.uk>
Sent: 30 June 2021 16:42
To: Winter, Maree <mwinter@eastlothian.gov.uk>
Subject: Re: Provisional premise licence application - The Cheese Lady

CAUTION: This email originated from outside of the organisation. Do not click links or open attachments unless you recognise the sender and know the content is safe.

Hi Maree,

Thank you for your email.

I'm happy to change it to 11am. In reality we'll be probably serving wine only from 12pm anyway.

Kind regards,
Svetlana

www.thecheeselady.co.uk
3 Court Street, Haddington
East Lothian, EH41 3JD
01620 823 729



On Wed, 30 Jun 2021 at 13:40, Winter, Maree <mwinter@eastlothian.gov.uk> wrote:

HI,

From: Lothian Scot Borders Licensing East Mid Lothian
<LothianScotBordersLicensingEastMid@Scotland.pnn.police.uk>
Sent: 15 June 2021 13:50
To: Licensing <licensing@eastlothian.gov.uk>
Subject: RE: Application for a provisional licence - the Cheese Lady, 3 Court Street, Haddington [OFFICIAL]

CAUTION: This email originated from outside of the organisation. Do not click links or open attachments unless you recognise the sender and know the content is safe.

OFFICIAL

Good afternoon

There are no Police objections.

Graeme

Graeme Bairden
Constable 4269 J
Licensing officer
Police Scotland - J Division- East Lothian
Telephone - 07866 195214
Email - graeme.bairden@scotland.pnn.police.uk



POLICE
SCOTLAND
Keeping people *safe*
POILEAS ALBA

EAST LOTHIAN COUNCIL

PEOPLE AND GOVERNANCE

From: Rudi Fruzynski
Licensing Standards Officer

To: K. MacNeill
Clerk to the Licensing Board

Date: 14 July 2021

Subject: LICENSING SCOTLAND ACT 2005
PROVISIONAL PREMISES LICENCE APPLICATION

The Cheese Lady, 3 Court Street, Haddington, East Lothian EH41 3JD

I refer to the above subject and can confirm that the applicant has fully liaised with the LSO in relation to this application.

Licensing Standards has no objection to the grant of this licence.

R. Fruzynski
Licensing Standards Officer

Herkes, Gillian

From: Millar, Neil
Sent: 25 June 2021 15:49
To: Winter, Maree; Licensing
Subject: RE: Application for a provisional licence - the Cheese Lady, 3 Court Street, Haddington

Hi Maree,

I have no comments or objections to make with regards to the grant of a provisional premises licence at 3 Court Street, Haddington.

Regards

Neil

From: Winter, Maree <mwinter@eastlothian.gov.uk>
Sent: 14 June 2021 15:51
To: Fruzynski, Rudi <rfruzynski@eastlothian.gov.uk>; 'Licensing@nhslothian.scot.nhs.uk'; torquil.cramer@firescotland.gov.uk; Environmental Health/Trading Standards <ehts@eastlothian.gov.uk>; Environment Reception <environment@eastlothian.gov.uk>; Grant, Shona <sgrant@eastlothian.gov.uk>; Lothian Scot Borders Licensing East Mid Lothian <LothianScotBordersLicensingEastMid@Scotland.pnn.police.uk>; [REDACTED]
Subject: Application for a provisional licence - the Cheese Lady, 3 Court Street, Haddington

Dear all,

Please find attached a provisional licence application from the Cheese Lady, 3 Court Street, Haddington. Could I please have any representations/objections by Monday 19th July 2021.

Kind regards

Maree.

Maree Winter
Licensing Officer: Accredited Registered Paralegal in Licensing Law: John Muir House:Haddington: EH41 3HA
Tel: 01620 827867: Email: mwinter@eastlothian.gov.uk

