

# Section 2 - Westpans

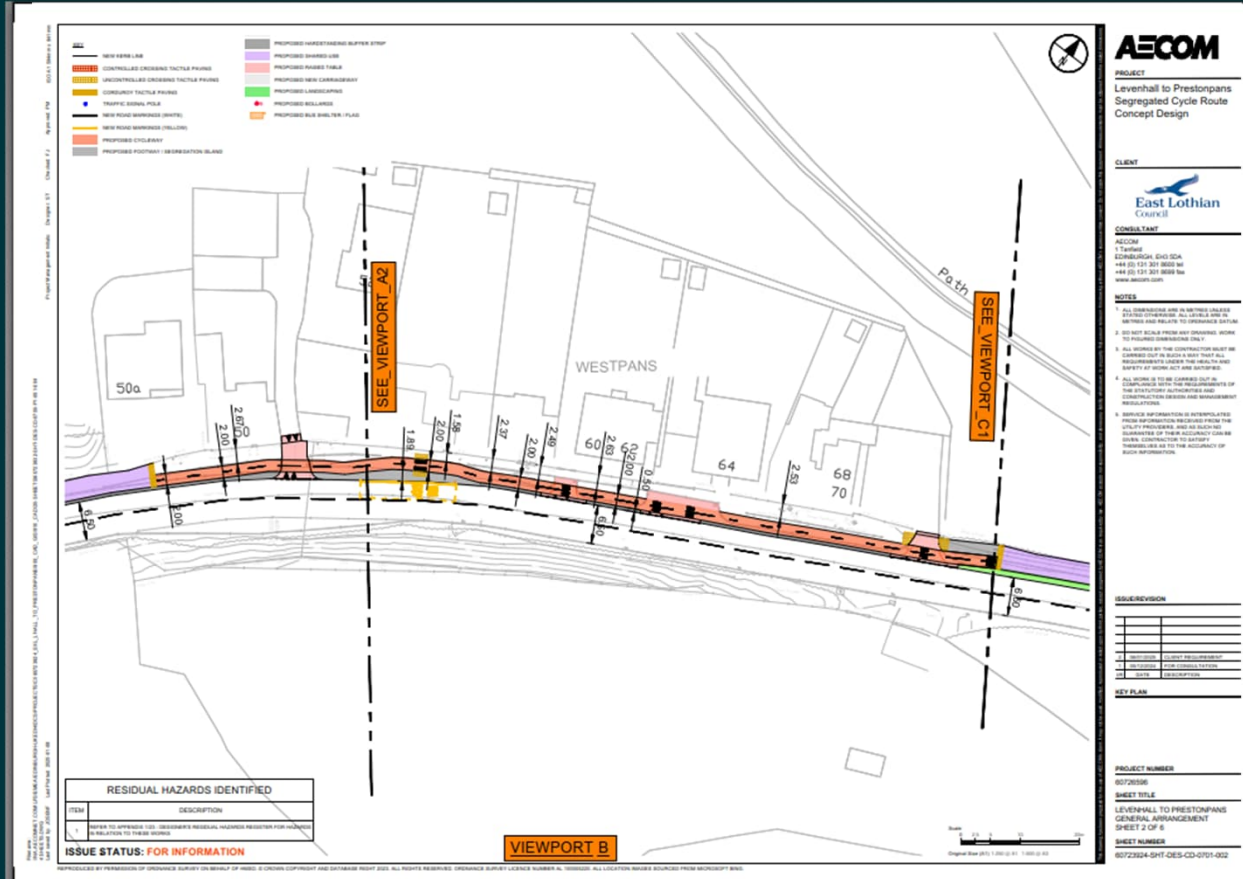

- This section continues the 4m wide shared use path for approximately 105m
- The route will then return to a bi-directional segregated cycle route to reduce conflict across property fronts and at the Prestongrange Heritage Park bus stop.
- This will include junction improvements at the property fronts and a mini crossing across the segregated cycleway to allow pedestrians to safely access the bus stop.

1. ALL DIMENSIONS ARE IN METRES UNLESS STATED OTHERWISE. ALL LEVELS ARE IN METRES AND RELATE TO ORDNANCE DATUM.
2. DO NOT SCALE FROM ANY DRAWING. WORK TO FIGURED DIMENSIONS ONLY.
3. ALL WORKS BY THE CONTRACTOR MUST BE CARRIED OUT IN SUCH A WAY THAT ALL REQUIREMENTS UNDER THE HEALTH AND SAFETY AT WORK ACT ARE SATISFIED.
4. ALL WORK IS TO BE CARRIED OUT IN COMPLIANCE WITH THE REQUIREMENTS OF THE STATUTORY AUTHORITIES AND CONSTRUCTION DESIGN AND MANAGEMENT REGULATIONS.
5. SERVICE INFORMATION IS INTERPOLATED FROM INFORMATION RECEIVED FROM THE UTILITY PROVIDERS, AND AS SUCH NO GUARANTEE OF THEIR ACCURACY CAN BE GIVEN. CONTRACTOR TO SATISFY THEMSELVES AS TO THE ACCURACY OF SUCH INFORMATION.

I/R	DATE	DESCRIPTION
2	06/01/2025	CLIENT REQUIREMENT
1	05/12/2024	FOR CONSULTATION

60726596

LEVENHALL TO PRESTONPANS  
GENERAL ARRANGEMENT  
SHEET 2 OF 6

60723924-SHT-DES-CD-0701-002

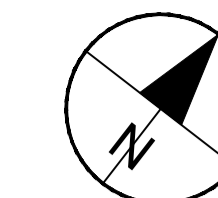

KEY	
	NEW KERB LINE
	CONTROLLED CROSSING TACTILE PAVING
	UNCONTROLLED CROSSING TACTILE PAVING
	CORDUROY TACTILE PAVING
	TRAFFIC SIGNAL POLE
	NEW ROAD MARKINGS (WHITE)
	NEW ROAD MARKINGS (YELLOW)
	PROPOSED CYCLEWAY
	PROPOSED FOOTWAY / SEGREGATION ISLAND
	PROPOSED HARDSTANDING BUFFER STRIP
	PROPOSED SHARED-USE
	PROPOSED RAISED TABLE
	PROPOSED NEW CARRIAGEWAY
	PROPOSED LANDSCAPING
	PROPOSED BOLLARDS
	PROPOSED BUS SHELTER / FLAG

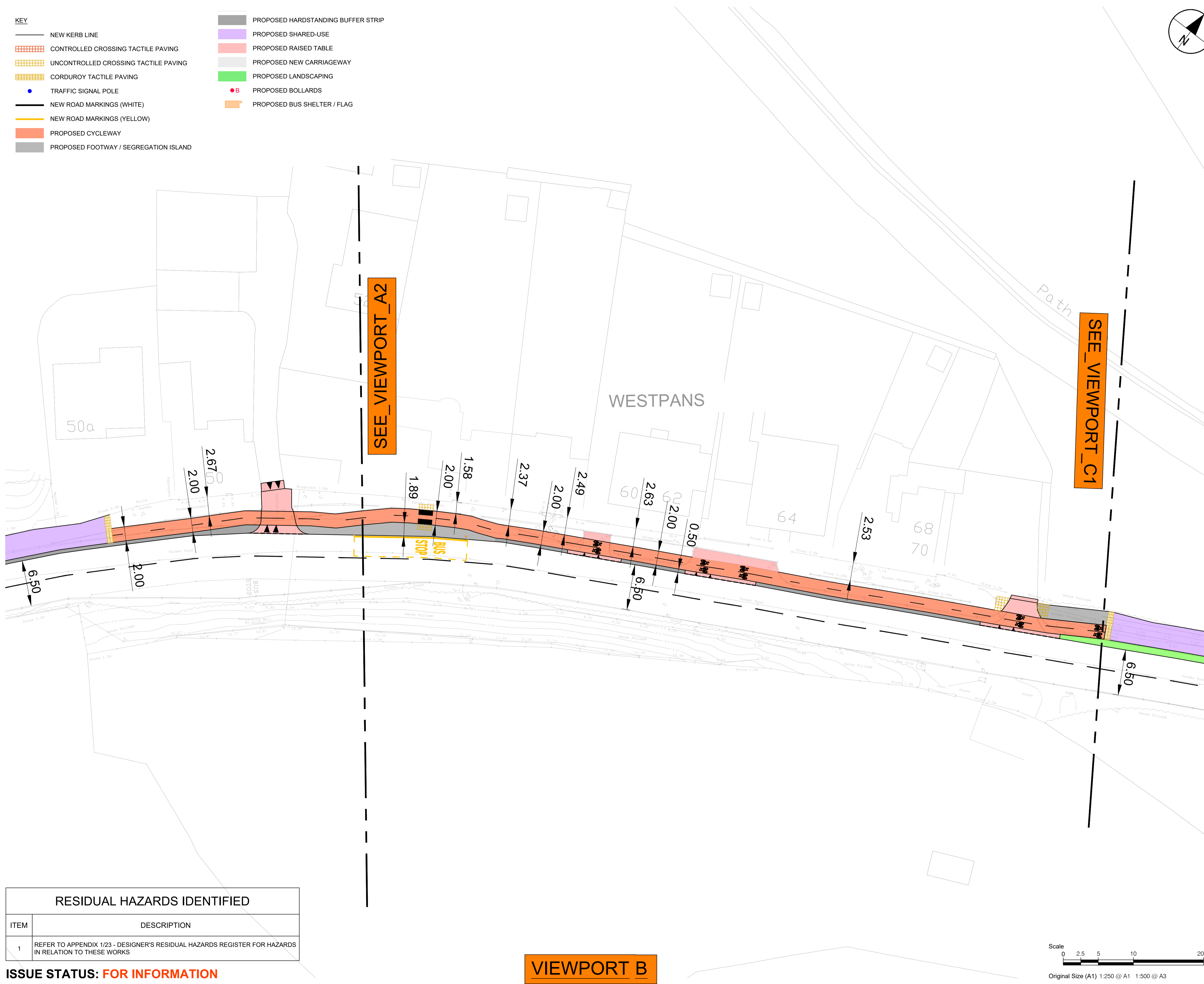

**VIEWPORT B**

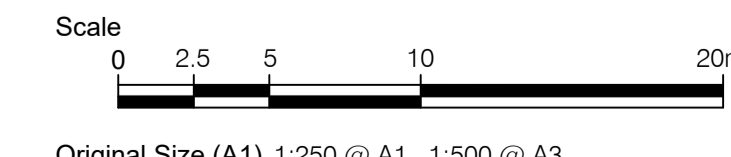

RESIDUAL HAZARDS IDENTIFIED	
ITEM	DESCRIPTION
1	REFER TO APPENDIX 1/23 - DESIGNER'S RESIDUAL HAZARDS REGISTER FOR HAZARDS IN RELATION TO THESE WORKS

ISSUE STATUS: **FOR INFORMATION**

File name: \\NA.AECOM\NET\COM\LF\SE\EA\NE\INBURGH\UK\ED\4\DCS\PROJ\60723924-SHT-DES-CD-0700-P1-001-004  
 4 SHEETS DWG  
 Last saved by: JOSENF  
 Last Plotter: 2025-01-08  
 ISO A1 594mm x 841mm  
 Approved: PM  
 Checked: FJ  
 Designer: ST  
 Project Management Initials:

This drawing has been prepared for the use of AECOM's client. It may not be used, modified, reproduced or relied upon by third parties, except as agreed by AECOM or as required by law. AECOM accepts no responsibility, and denies any liability, whatsoever, to any party that uses or relies on this drawing without AECOM's express written consent. Do not scale this document. All measurements must be obtained from the stated dimensions.